

1 - BIG ISLAND 1983-84  
G.H. BACAZS

PUNALUÚ  
HILO

1983-84

FIELD WORK

- 12-13 September 83 . . . . . p. 3
- 23-25 September 83 . . . . . p. 22
- 24-28 November 83 . . . . . p. 39
- 15-20 DECEMBER 83 . . . . . p. 68
- 8-10 JANUARY 84 . . . . . p. 91

G. BALAZS

ALL J.A.  
 (7451-7500  
 7501-7527  
 7551-7569)



TAG SERIES' USED -

- 6707-25
- 7203-7216
- 7528-7550; 7570-7600
- 7601 -

COMPOSITION BOOK

9 3/4 IN. x 7 1/2 IN. (24.8 cm x 19 cm)

AVAILABLE AS:

- No. 09-9130 (1130) 60 SHEETS COLLEGE RULED & MARGIN
- No. 09-9132 (1130-P) 60 SHEETS COLLEGE RULED & MARGIN
- No. 09-9134 (1143-X) 100 SHEETS COLLEGE RULED & MARGIN
- No. 09-9132 (1130-P) NUMBERED PAGES

Made in U.S.A.

> SEPT 83

TAG Summary p. 110

VERNON McMILLAN, Inc., ELIZABETH, N.J. 07208

3519, 20 hawkbill

BIG IS, SUMMARY ON NUMBER TAGGED . . . p 116-117

Walt Dudley - Home - 935-6987 SS 239-74-6002

Camela Office - 961-9544 mop; 961-9411

WILL ORCUTT - 961-3221 Home.

ALOHA AIRLINES - OAHU - 836-1111

MIDPACIFIC - HILO - 935-5771  
HONOLULU - 836-3313  
HILO - 329-8017

TROPICAL (HILO) - 935-3385  
HARPERS - " - 969-1478  
SEA GRANT

HOWARD TAKATA - 935-3830  
Ke-ahole 329-6767

HILO HOTEL - 961-3733

- Roy S. Blackshear <sup>with</sup> "Shipman Estate" 966-9325  
<sup>11/22</sup> mailed literature + letter ARLO FAST - PONDS (WIFE INTEREST IN TURTLES) P.O. Box 950 KEAAU, HI 96749

Howard Takata - 935-3010 (home)

Don 822-3834 - home - KAUAI

Pete Hendricks - 885-4453 (home)

KAU PARKS & RECREATION - 929-7189 (Janet)

Nelson Santos - 961-7573

HARPERS - 969-1478 15-19 DEC Theresa #30

UH - HILO

P.O. Box 1357

HILO 96720

MR. A. HOWARD 928-8156

Bob Nishimoto - 961-7501

Sherwood - 948-(8444)

DOCARE - HILO 961-7291 (8433)

DAR HONOLULU - <sup>MIKE</sup> YAMAMOTO 548-4371  
MAIN OFFICE 9002

Russ Apple, Box 32, Hawaii Nat. Park - 96718

MID-PACIFIC AIRLINES

TO HILO		
FROM HONOLULU		
Leave	Arrive	Flight No.
7:10 am	8:08 am	40
10:10 am	11:08 am	44
1:15 pm	2:13 pm	48
5:35 pm	6:33 pm	58
6:45 pm	7:43 pm	112

FROM HILO		
8:40 am	9:38 am	41
11:40 am	12:38 pm	45
2:45 pm	3:43 pm	49
7:05 pm	8:03 pm	59
8:15 pm	9:13 pm	113

9-11-83

3

Telephoned Walt's home from home -  
charged to HMB,

12 SEPTEMBER 1983

MONDAY

P.O.V. to airport

Depart for Hilo on Aloha Fl. 210  
at 11:40 am - Big Island Sea Grant  
Project.

Some Objectives

1. Identify and meet with potential student workers.
2. Survey potential study sites in the Hilo Bay area (Sewage treatment plant, & King's Landings Shipman Estate);
3. Camping equipment, van, outboard motor, zodiac availability
4. Water Chemistry analysis possibilities
5. Schedule field activities (Thanksgiving weekend possible)

9-12-83

MONDAY

Arrived Hilo - 12:50pm - came  
via Maui - used coupon = \$37.50,  
Rented Tropical Rentals \$12.50.  
Drove to UH - Hilo and  
Walt's office. Talked at MOP  
office for hours. Nancy arrived.  
Meeting with students held at  
4:30pm. Good turnout.

Met Lisa Hall who has worked  
with hatching turtles in Florida.  
She knows of a Hawaiian man  
who sets net at "Kings Landing" -  
just past site where Harbor was  
to be constructed. Catches  
turtles and puts them alive  
in his car. Will take us to  
site tomorrow.

<sup>MAZARAKIS</sup>  
Diane - student MOP coordinator;  
boyfriend full Hawaiian. Turtle  
recently tangled and died in  
net just Mackenzie Landing.  
From cliffs turtles can be  
seen swimming in this area.

<sup>KAICHI</sup>  
Wills' oil rig diver, reports that  
turtles are regularly seen at

the end of Makua Drive in Hawaiian Paradise Park.

John Wiltshire - MSB 3<sup>rd</sup> floor  
 can obtain access to Shipman Estate, owner Mr. Roy Blackshear.  
 966-9325

Topics that we offered students included the following; Stipends Available.

1. SCUBA ; SCUBA/Boat assistance
2. Net setting
3. Water Chemistry
4. Interviewing for local information
5. Snorkel census
6. Observational project
7. one's own creation

Dinner at Burger King; Rain all night until ~ 9am 9/13 TUES.

9-13 TUESDAY

UP ~ 730am; walked to Post office, had breakfast at MacDonalds, checked out of HILO HOTEL ~ 10am.

9  
1

- Project needs -

1. System for tagging & releasing turned-in turtles; and salvaging dead turtles for autopsy. Freezer? J. Takata Involvement

2. <sup>Shorts</sup> Project press release: Brief outline + ABOVE + letter asking for information

3. Contact Roland Almaraz

4. Assemble literature & data logs & A&E documents.

5. Willig - to receive "double" stipend, (Last name? #100 month, as project leader. NOT ON SIGN-UP LIST)

6. Articles for all students



At 12 noon, CISA, HALL and I drove  
to road's end - leleiwi. hiked across  
cold freshwater pool to rocky shoreline. CISA  
indicates flat area - grassy, one palm tree, Hawaiian  
man sets nets to catch turtles.

Maui Transecting Workshop  
21-28 1982 DAF

Develop  
"UNDERWATER TRAILS" - one being  
considered for off Olowalu, Maui

- Michael Baldonado - Kau - 257.0,  
catches turtles - PAHALA  
left at  
M.O.P. TAGS # 6707 - 6725 (19)  
AND Plier with > spring.

Stephany Salazar - MOP student  
KPVA radio station

Scuba diving class offered by MOP Hilo  
over Thanksgiving Holiday  
Also all students will be asked to take  
CPR & Red Cross courses.

19 DEC 83 - 13 JAN 84 Christmas break

Week of 21 March 84 Spring break

SEA GRANT

ACCOUNT NO. F84-238-F-SP2-B-323

8 9-13-83

TUESDAY

JOAN STIPEND  
SNOOK - - Procedure  
(ORA) - Check transmits/  
- 1 Oct. start-up  
- forms needed

LISA > INTERVIEW TO LOCATE  
DIANE > NETTING/DIVING SITES CLOSE  
TO HILO WITH TURTLES -  
ROAD ACCESS.

9-22 Bound data books sent to each of the above  
RESERVE VAN

NOTED - "WAITONU POND" - largest  
 (sole) WITHIN LILIOKALANI  
 GARDENS - ACROSS FROM COCOANUT  
 ISLAND - HILO BAY WATERFRONT.

CISA HALL Reports that surfers  
 see large turtles, with tags, at  
Honolii - just before Japanese cemetery  
 north of Hilo. Road goes down  
 to a surfing spot.

, Also, lots of small turtles seen  
 off new boat ramp (Pokoiki?) - Puna  
 District.

9-13-83 Depart Aloha FL 67 5:15pm  
Tuesday for Honolulu via Maui,  
Arrive.

9-14-83 8:30pm Telephoned Walt about

1. Stipends
2. Blackshear<sup>966-9325</sup> - Shipman Estate - Keauu
3. Van Rental - Harper's cheapest
4. experience of divers - water skills
5. Willy (ORUH)
6. Bring Kam AS AN INSTRUCTOR FOR NET SETTING AND MAINTENANCE

Gear needed for netting:

- TUBE
- ANCHORS, line, buoys, chain
- NETS; (MEND?) MEND NEEDLE & LINE
- 

OTHER -

- CALIPERS
- DATA BOOKS
- MORE TAGS, PLIERS, NEEDLE-NOSE +
- Blood sampling
- ACONYM; TEAM SPIRIT; "Newsletter" possibility.
-

THOSE SCUBA CERTIFIED:

NAME	AREA OF INTEREST (SCUBA, Netting, Chemistry)	COULD WORK OVER SCHOOL BREAKS
1. <sup>ORCA</sup> William Orcault *	Scuba (961-3221)	YES
2. Nancy Bernard	Scuba 965-7839	YES
3. Miles Kaichi	SCUBA / ANYTHING * 966-7772	YES
4. David Clements	SCUBA - anything	?
5. DEAN ENGLE	SCUBA 935-2423	YES
6. Kelvin Lau	SCUBA - ANYTHING 961-9935	YES
7. Chris Doll	SCUBA / Netting / Chem.	YES
8. JOHN WOERTENDYKE	ALL ABOVE	YES
9. LISA HALL	SCUBA, NETTING (ALL) 961-3861	YES

- 10. JOHN Cowley ✓ SCUBA, Netting, Tagging, ~~Sampling~~ NO CHEM Yes
- 11. Kumberby Bailey ✓ Photography Aspects - Dive! Some
- 12. Sheila Mahony ✓ diving, tagging, food studies, netting yes
- 13. Gilbert Chan ✓ Scuba, netting, \*chemistry yea
- 14. Darrell Kuimoo ✓ scuba, netting, tagging, 959-9327 yes
- 15. DIANE MAZARAKIS ✓ SCUBA, NETTING, INTERVIEWING COMPILING + COORDINATING INFO YES 9359260
- 16. Doreen Johnson ✓ ⊗ tagging, netting, data work yes.
- 17. Bob Laube ✓ SCUBA - (935-7350) 100 Linikai yes?
- 18. Bill Harkin ✓ SCUBA = Chem. 959-3888 yes
- 19. Toshi Ariga ✓ ARIKA = UW PHOTO yes

O C E A N



SITE FOR  
LELEIWI PLAN

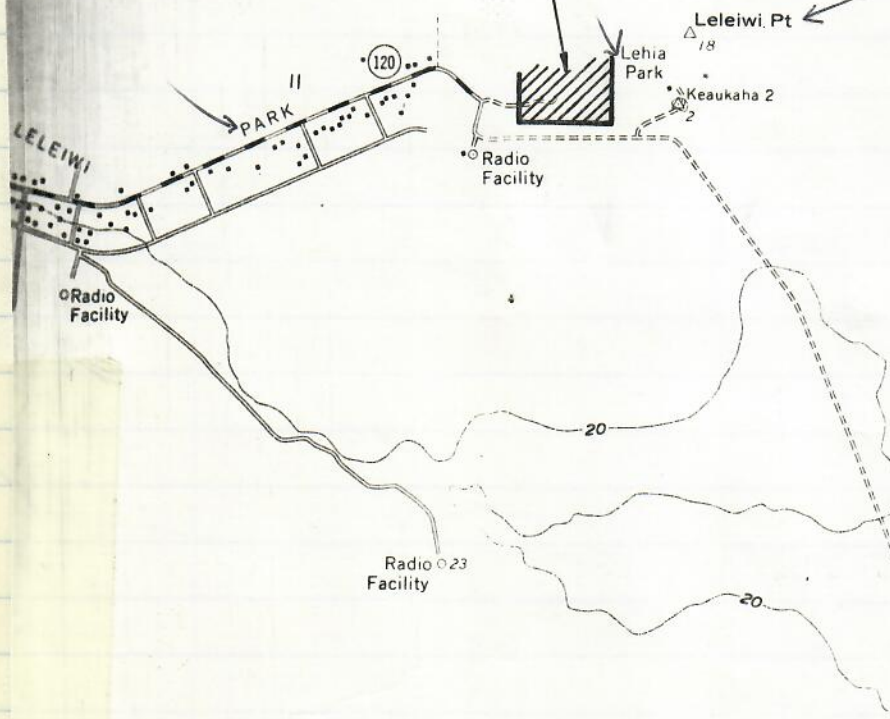

W A I A K E A

Anapuka

SITE FOR  
KING'S LANDING  
PLAN 2



Paukupahu

SITE FOR  
KING'S LANDING  
PLAN 1

GRAPHIC SCALE

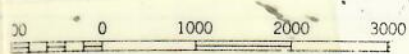

SCALE IN FEET



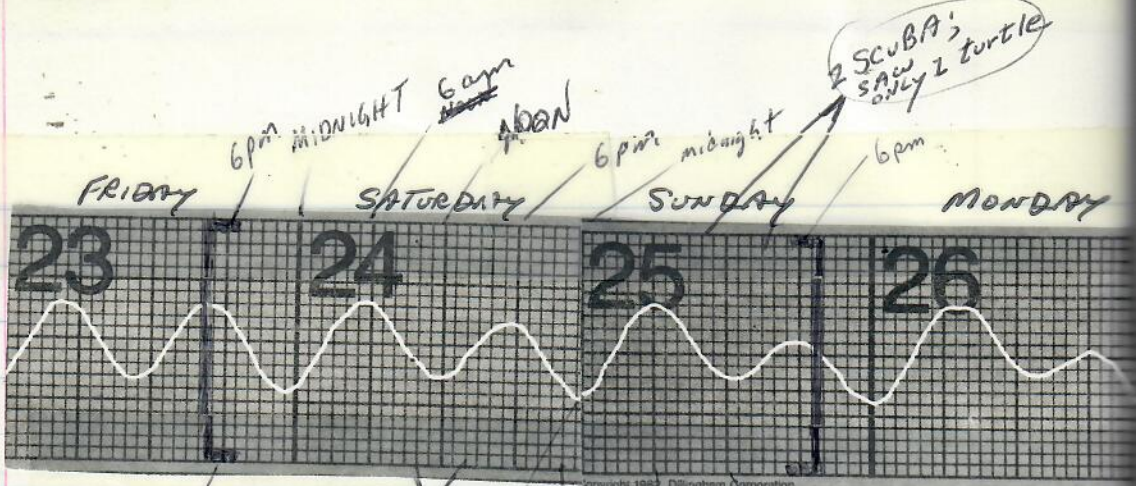

Depart Honolulu

1 SCUBA; caught 2 turtles

SWIMMING

6am NOON

add or subtract from Honolulu time.

PORTS	Hrs.	Mins.
KAUNAKAKAI, MOLOKAI	-0	09
KAHULUI, MAUI	-1	48
KIHEI, MAALAEA BAY, MAUI	-0	14
HILO, HAWAII	-0	59
HONUAPO, HAWAII	-0	24
MAHUKONA, HAWAII	-0	24
KEALAKEKUA BAY, HAWAII	-0	16

**MOON PHASES**

NEW MOON SEPT 6	FIRST QUARTER SEPT 13
FULL MOON SEPT 21	LAST QUARTER SEPT 29

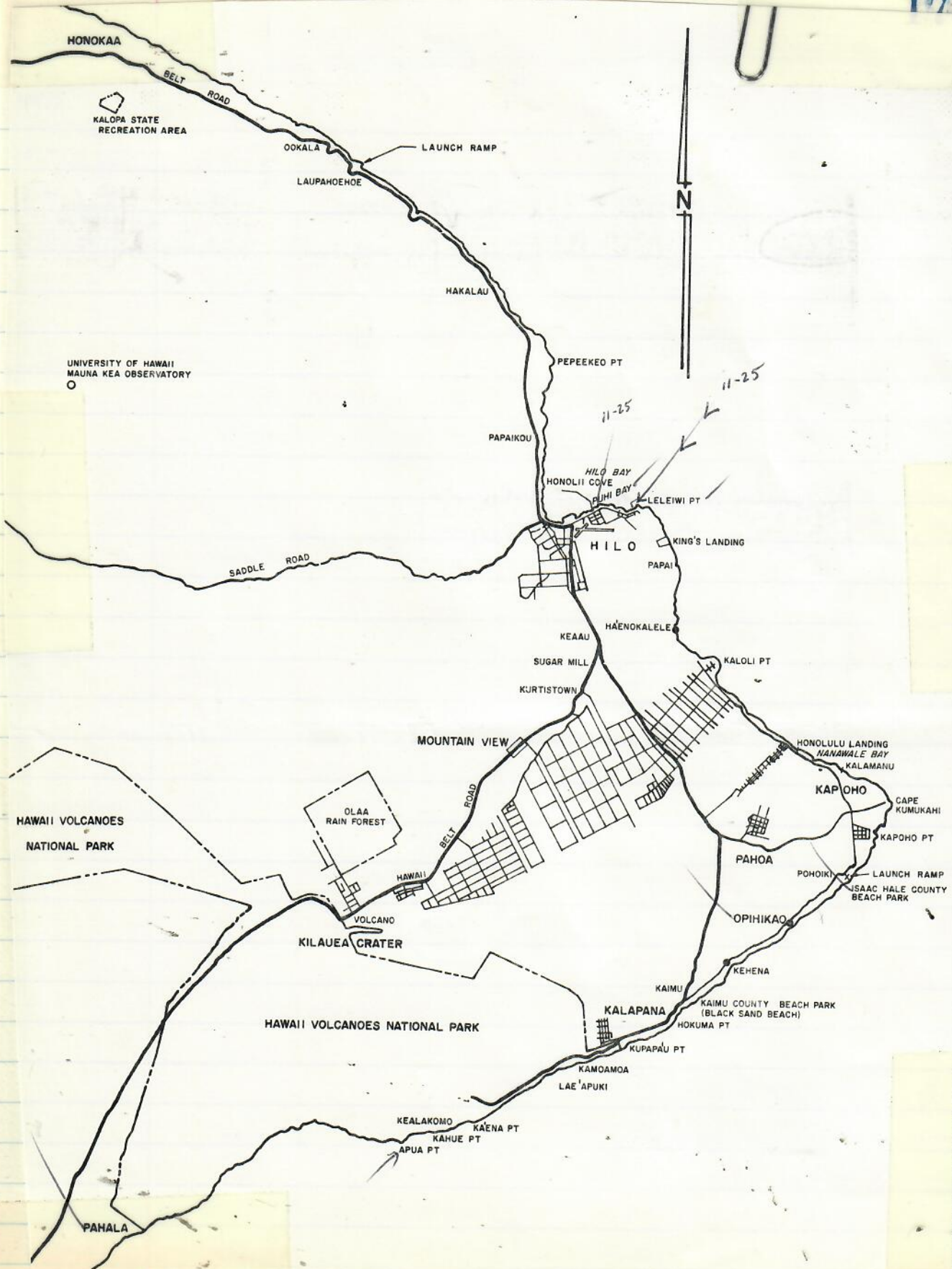

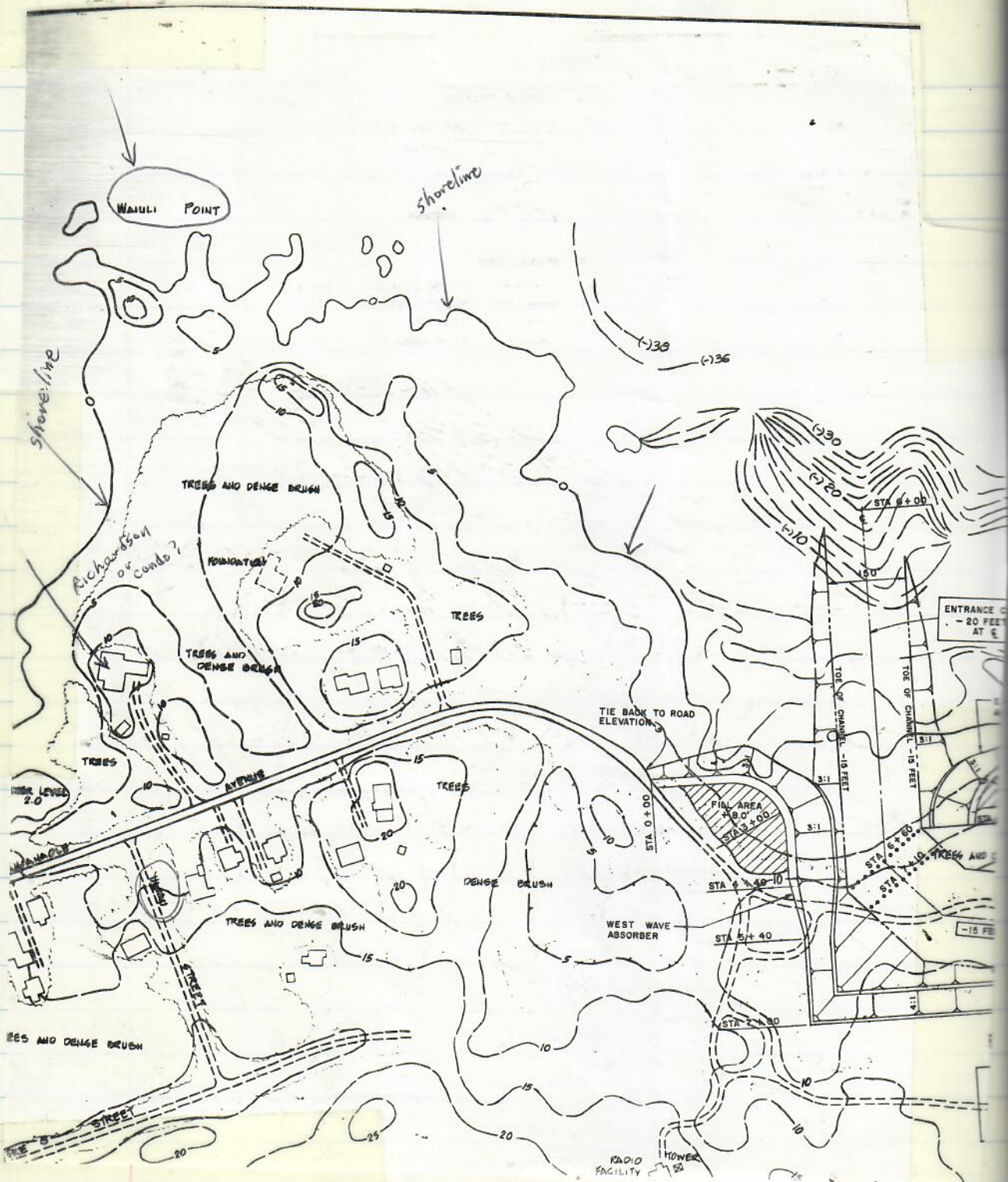

**NOTES:**

1. ALL ELEVATIONS AND DEPTHS REFERENCED TO MEAN LOWER LOW WATER DATUM (MLLW).
2. CONTOUR INTERVAL:  
TOPOGRAPHIC SURVEY - 5 FEET  
BATHYMETRIC SURVEY - 2 FEET
3. DATE OF SURVEY:  
TOPOGRAPHIC SURVEY MARCH 1973  
BATHYMETRIC SURVEY APRIL 1981
4. ORIGIN OF COORDINATES: HAWAII PLANE COORDINATE SYSTEM, ZONE 1.

**LEGEND**

1. EXISTING CONDITION

- UNIMPROVED ROAD
- ==== PAVED ROAD
- HOUSES / BUILDINGS
- DEPRESSION

2. RECOMMENDED

- HARBOR STRUCTURES (FEDERAL)
- TOE OF STRUCTURES
- - - DREDGING LIMIT
- ..... DEPTH TRANSITION

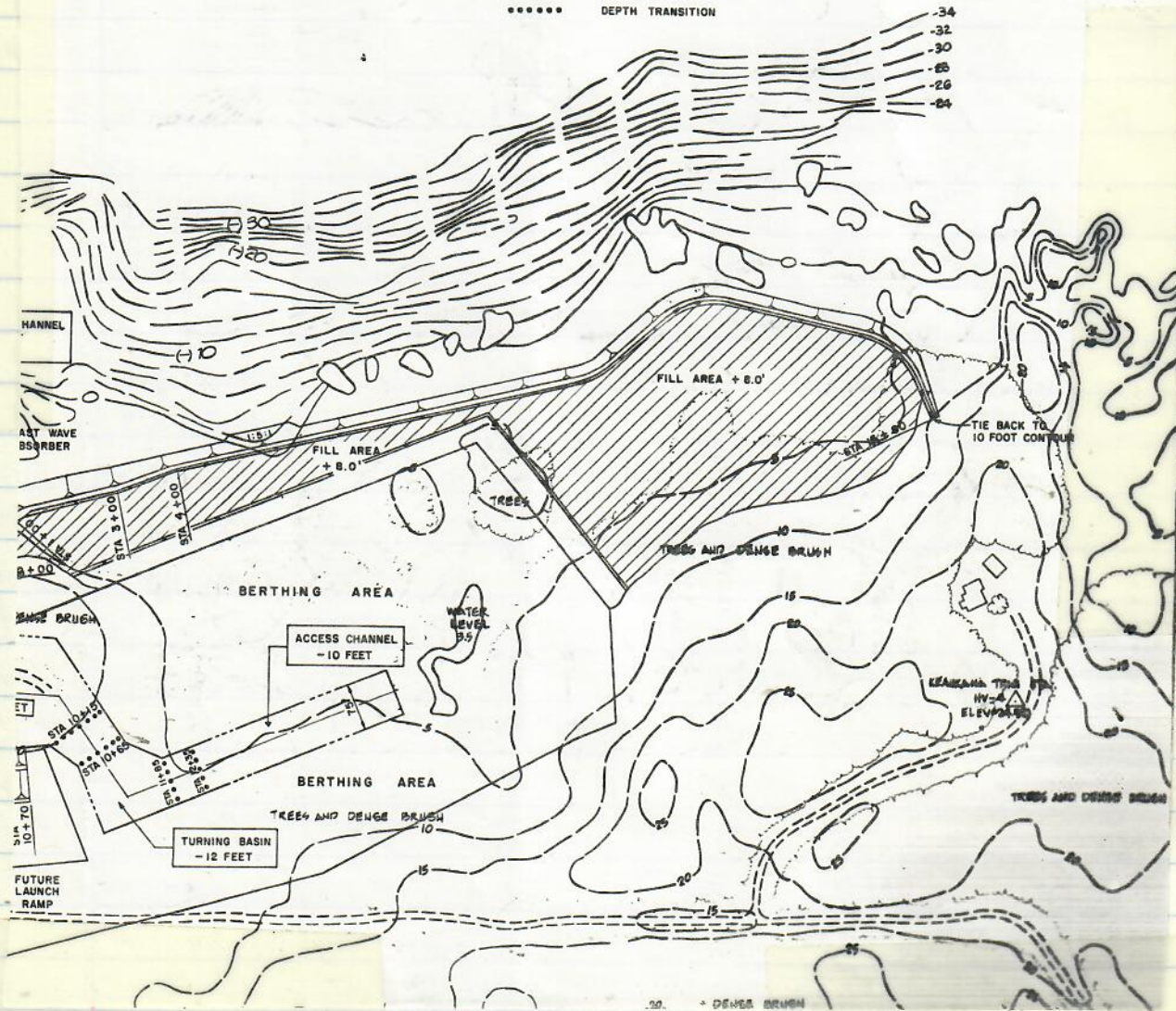

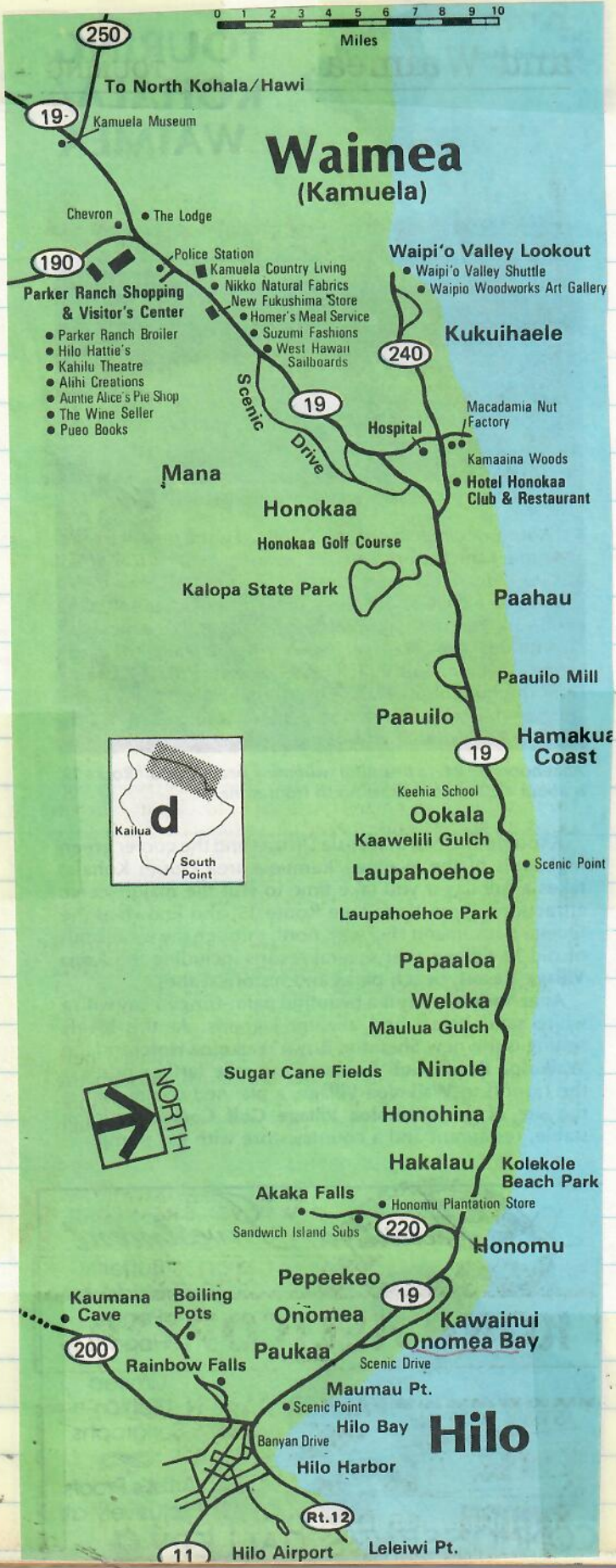

Del Dykes - 335-4372 work  
337-1022 home

9-22 telephone conversation requesting info on Lelewi site where he previously saw turtles. Said that shore entry was at cement wall at end of paved road; smooth, slippery boulders. From entry here, turn to the left toward condominium. 20-40' depth. Turtles seen in the daytime.

Another safer entry <sup>EXIT</sup> is a deep surge channel on the condominium-side of Richardson Center. A larger swim, but better.

A second area for turtle sightings is between Puhii POC and Yacht Club. A place called "Finger Reefs" is off here. Decent entry at Yacht Club.

Del has snorkeled Lelewi at night for lobsters - no turtles seen. Never bothered by sharks.

23 SEPTEMBER 83

FRIDAY

Hilo via MAUI  
 Depart Aloha FL 218 3:45pm  
 with A. Kam from main terminal  
 5 pieces of excess baggage - 9 to  
 includes 4 older nylon nets recently  
 restuffed in 1 quart varathane, 2 gal  
 paint thinner; 3 danforth anchors  
 and chain, plastic floats, line,  
 old inner tube & "stick".

## OBJECTIVES:

1. TRIAL SCUBA DIVES TO TEST STUDENTS' SKILLS
2. Selection of close study area
3. Demonstration of search for, capture of turtle
4. Introduction to use of nets

x Need Home phones of various students.

23 Sept. 83

23

Arrived Hilo ~ 5pm. Rented a Tropical car. Jan took our bags to Hilo Hotel. Checked in \$16 for 2. Called Walt at home.

Drove out to Lelewi Pt. end of paved road. Many mosquitos, 2+ camp fires - campers. Waves noted at cement wall area. Area off road to Condo had far less waves. Pulled off road at Lelewi Park, Kealoha Park, and unnamed Hawaiian Home's land park next to sewage treatment plant. All 3 look promising - safe for night dives with lights looking for turtles.

Dinner eaten at Leung Chinese Restaurant.

24 Sept  
SAT.

Up ~ 6:30am - Drove out to Lelewi Point again; out sewage treatment plant road. Walked from Richardson Center along ~~the~~ shore (point) - Condo is set back behind trees. observed various entrances for Scuba. Met at University at ~ 8:30am



24 Sept  
Sat.

Reviewed goals, had net demonstration  
transported gear & 12.5' inflatable  
to Richardson Center, launched -  
Walt transported me & Alan out, then  
went back for Nancy and Will.  
John snorkeled out for his Ju  
Toshie, Miles and Bob Scuba  
from shore - saw 3 turtles - caught  
one and let it go.

Scuba offshore started at ~10:30am  
swam to left side (north) point  
then toward Richardson-side  
point. Depth ~35-40'. No turtles  
seen during first 30 minutes; then  
Alan found one inside a lava  
depression. Pulled out and taken  
back to the boat. Second turtle  
later grabbed by me resting on  
top of smooth boulders - toward  
Richardson-side Point.

(Amansia seen washed on beach  
in front of Richardson Center)  
+ fresh Codium & Pterocladia

Second turtle (adult male) was  
laying on surface of boulders when  
caught. Let me swim right up to it.  
After grabbed fore and aft air shells,

swam up a short distance, and then  
back down into a hole between two  
boulders. Stayed there motionless.  
Alan came down and each of us  
grabbed the end of the a flipper  
and took the turtle back to the  
inflatable.

Capture #1 9/24/83

7213 RFL S - 69.8 x 56.3 cm

7214 R 3-4<sup>th</sup> web C - 76.0 cm

7215 LFL HEAD - 9.6 cm

7216 L 3<sup>th</sup> web Tail & PL - Not measured

Post-centrals somewhat "rounded"  
old injury?

24 SEPTEMBER, SATURDAY  
1983

2<sup>nd</sup> Capture

7209 LFL

S - 84.1 x 62.7

7210 L 3-4<sup>th</sup>

C - not taken

7211 RFL

7212 R 3-4<sup>th</sup>

PL - 66.7

HEAD - 11.5

TAIL length - 32cm approx.

Flipper width - 15.1 cm

Appears to be an adult male, but no signs seen of scars on front flippers indicative of participation in a breeding season.

Punchy (Robert) Kim arrived in his aluminum boat while we were bringing in the second turtle - provided considerable help.

↓ (\* Send him a poster.

24 Sept. 83

\* Pressure to DIVE/CATCH TURTLES

\* - Equipment at MOP - BC's; wet suits;

\* - Check on Grigg Zodiac / outboard - <sup>KEEP</sup> ~~INFLATED~~\* - Student usage of UH equipment - <sup>Sherwood (MOP coordin.)</sup> Heltrich; <sup>Zool. Dept.</sup>

Cleaned all gear at UH - Walt left to mount outboard bracket on their donated boat. Leon arrived for same reasons. <sup>Hallacher</sup>

Left at hotel room for 2 hours.

At 10 pm we picked up Bob Canbe and met Toshi 2 miles at Richardson Center. Snorkeled with lights the entire inner region.

Lots of habitat that appeared suitable for resting turtles, but no turtles seen. *Hydrocladia* growing on rocks in shallow in areas of fresh-cold water.

Need - ① Memo summary of trip!

② More "follow-up" on letter of inquiry -

telephone Roland Almarza  
Moses

+ Second letter to Cooper.

③ Send "Master" data book to Willy ✓

④ Interview data book to Wendy ✓

Items left at MOP: 7 nets (one needs mending,  
UNTRANGLING)

1 fiber drum (anchor line  
net needle, etc.)

3 anchors

1 float (plastic)

1 weight belt (10 lbs)

2 12-volt seal beams

1 collapsible water jug

1 inner tube on plywood

Previous

2 white plastic buckets

1 100cm-long tree caliper

September 25, 83

Sunday

Met Willy and Lurchy Kim (Robert) at MOP office at 9am. Transported boat and gear to Richardson Center. I motored out and we anchored more toward the channel side. Willy and I swam scuba to area where turtles were caught last time. Proceeded to channel area. One ~20" turtle seen swimming - I approached close -- but not close enough to catch it.

Returned to shore ~12 noon. Rested and ate crackers. Returned to anchor just outside channel. 2nd scuba was along and in channel. No turtles seen. Anchor set ~35', but 25 yards outside of here there is a very sharp drop off. Not investigated due to low air supply and residual  $N_2$  (bottom time).

Made 2 trips to return gear to UH. Walt came ~3pm, with Willy when I arrived. Stopped by Community College to see donated boat and future storage area.

25 Sept 83

Departed on Aloha FL. 47, 6:20pm  
Direct to Honolulu.

9-26

MONDAY

Bob Nishimoto telephoned to say that Nelson Santos said that A. Howard saw a large turtle on its back at Kanehame "a couple weeks ago". But not there the next day.

"UNDERWATER TRAIL"

Also that legislators committee were interested in the future of Richardson Ocean Center. He felt it was good if this is developed into a green turtle study area for MOP. Stow gear the too.

10/25 Will called & said that ~ 10 people showed for night dive on 10/31 at Richardson. No turtles seen.

10/25 Called Walt at home.

10/28 Shipped Zodiac to Hilo - Aloha Airlines  
\$45.64

Sewage spill at Puhi Bay last Sunday.  
Will reports visit to be made to Puna in the near future.

11/1 Tues. Meeting with Helfrich - agreed to loan outboard.

11/2 State permit received & sent to Walt; will. said tagging demonstration will be held Saturday

QUESTION: Present students with the challenge of catching turtles. How would they go about it??



15 Nov 83 Interview with H&N  
Security Officer MOSES CABALLERO  
at Johnston Atoll (Saw on "TC 10")  
In the 1950's, he used to  
catch green turtles on the Big Is.  
(Knows of hawksbills there too) to  
sell commercially. Largest was 400 lbs.  
He never found one with a tag.  
He used to take meat from the  
wings, save the shell, and throw  
the rest away. Places he  
caught them included - Cape  
Kamukahi, and Opipikao near  
Lyak Hale Park in Puna. There  
is a large underwater cavern  
there where he saw numerous  
turtles swimming of fast when  
disturbed. Catch methods include  
ice hooks with rope attached  
to a rubber raft - when the  
turtles tires itself out they  
go get it. Also shot them  
with a .30-30 from the cliffs!

November 1983

RICHARDSON

10:30am DIVE 4 PUNAHOU BAY  
11:30 DIVE 5 PUNAHOU BAY

DIVES 4 & 5 (me, willy, Bob)

DIVE 6 (me, willy, Toshi) OFF NINOLE - 3 TRIPSED!

WED. noon  
THURS. 6am

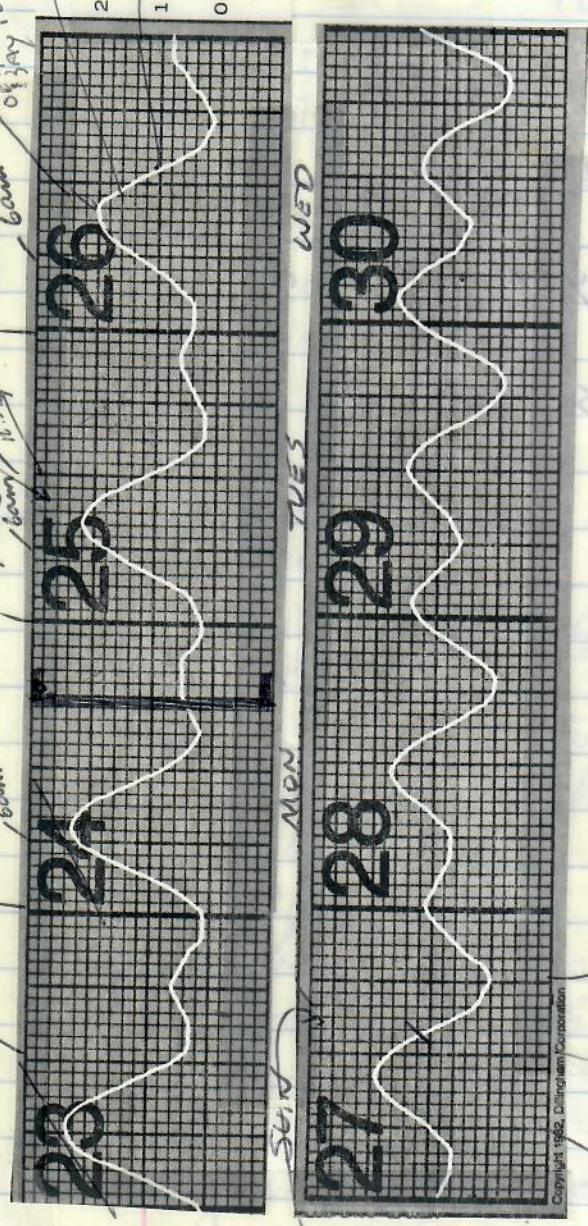

Copyright 1962, Dittorham Corporation

6am noon 6pm

DIVE 7 PUNAHOU BAY slope of 3 sec. of these, 1 captured

For tide time at following places, add or subtract from Honolulu time.

PORTS	Hrs.	Mins.	PORTS	Hrs.	Mins.
HANAIE BAY, KAUAI	-1	40	KAUNAKAKAI, MOLOKAI	-0	09
NAWILIWILI BAY, KAUAI	-0	32	KAHULUI, MAUI	-1	48
PORT ALLEN, KAUAI	-0	32	KIHEI, MAALAE BAY, MAUI	-0	14
HALEIWA, OAHU	-1	36	HILO, HAWAII	0	59
HANAUMA BAY, OAHU	-0	55	HONOLULU, HAWAII	0	00
KANEOHE BAY, OAHU	-1	35	MAHUKONA, HAWAII	0	24
KAHE, OAHU	-1	48	KEALAKEKUA BAY, HAWAII	-0	16
WAIANAE, OAHU	+0	16			
WAIKANALO, OAHU	-1	15			

MOON

Copyright 1962  
Dittorham Corporation

COMPUTER SHEET  
DATE

11/14	183 <sup>1</sup>	Bob LAUBE	#50.
11/2	2	William ORCUTT	100.
11/2	3	Nancy D. BERNARD	50.
11/2	4	John WOERTENDYKE	50. L <sup>2</sup> 11/25
11/2	5	Diane M. MAZARAKIS	50.
11/2	6	Miles KAICHI	50.

#350 month

11/20 Reservations made on Mid-Pac. 836-3313  
 Hono Depart FL. 58 11/24 5:35 pm; Arr. 6:33 pm  
 Hilo → Hono FL. 49 11/28 2:45 pm; Arr. 3:43 pm

Will - 1) check on State car

2) Phone in Zodiac ID for <sup>non-reg.</sup> letter  
 TROPICAL - \$19.95  
 Dollars ?

11/22

Steve Dollar reports that his  
 Mawa Lani report is completed.  
 No turtles found in ponds, but  
 at the "cottage" <sup>(caretaker house)</sup> one day at sunset he  
 saw 6-10 turtles in reef area  
 ("lagoon") right off shore. Ponds  
 near ocean are fresh water on  
 top lens, but salt (30 parts)  
 below. Ponds further back from  
 shore are far more fresh water.

Big Is. Map - See file  
 TAGS

Hydro. on Kim's bottles + vif. ?

— PRIME OBJECTIVES —

1. DIVE AND CATCH TURTLES
2. NET AND CATCH TURTLES
3. COMPILE EXISTING HISTORICAL & OBSERVATIONAL INFORMATION ON TURTLES
- 4.

NOTE: PROJECT HEAVILY WEIGHTED  
TOWARD JAN - JUNE OF 1984  
DUE TO CIRCUMSTANCES  
BEYOND MY CONTROL.  
REGRETTABLE, BUT  
THIS IS CERTAINLY BETTER THAN  
NO PROJECT AT ALL.

24 NOV 83

Thursday (Thanksgiving Day)

Depart Mid Pacific 5:35 pm TO HICO,

cost of RT -  
Arrive Hilo ~ 6:45 pm

## PROJECT OBJECTIVES:

1. Scuba with students who have now received UM certification at my project expense; Evaluate skills & safety - instruct in such.
2. Evaluate - instruct in safe use of Zodiac & outboard recently sent from HUMB to Hilo on loan to project.
3. Collate and utilize interview information obtained by history/culture/ID sites - component of project (Diane one part complements the other, i.e., Diane <sup>etal</sup> locates high density sites of turtles - WILL <sup>etal</sup> surveys by scuba.
4. Review methods of data collection - both for scuba surveys (DIVE LOGS) and Interview Narratives.
5. Instruct in UW scuba search methods for turtles - impress importance of systematic, repetitive scuba surveys.
6. Instruct in diving procedure at Punaluu - introduce to habitat.

40 Need TAGGING DATA from 2 TURTLES -

MILES > TEL. NOS. =  
TOSHI  
DIANE

24 NOV 83

Rented Tropical -  
Drove to Hilo Hotel - Room 115  
- double bed and 2 singles.  
Ate dinner at Ken's.

25 NOV 83

FRIDAY

AFTERNOON - CALLED DON HERROCK AT HIL  
CONCERNING 28" TURTLE FOUND WORK  
IN RIVER - HE WILL TAKE AND  
RELEASE. Change to NMFS

Noted - Difficulty of PLANNING SPECIFIC  
DATE TRIPS TO HILO DUE TO  
UNPREDICTABILITY OF WEATHER.  
WORK THEREFORE NEED ON AN  
AD HOC, AS WEATHER PERMITS, BASIS.

Up 6am - Breakfast at McDonalds -  
Met Will (and Punchy) at  
MOP office. Drove to Hilo  
Community college where zodiac  
was deflated on trailer. Boards  
never put in properly - I  
instructed - also put temporary strip  
on "flex" beam of boards. Spent  
some time reviewing project  
policy, etc.

- SERIAL NO. ZODIAC?  
- LENGTH of chain  
WEEKEND

- USE OF STATE VEHICLE?

- NO. PEOPLE IN ZODIAC? - SEE WEIGHT SPEC. ON PLATE

- Wash Calipers - Aluminum

- FILING OF MONTHLY DIVE LOGS?  
DIVE MASTER

NEEDS - UH DIVE REGULATIONS COPIES?

- DEPTH GAUGES? YES

- USE OF MANDA EQUIPMENT ARRANGED?  
TYPE OF GEAR? CAN'T EXPECT PERSONAL GEAR USE AS

#50 from John refund. CASH ADVANCE TO WAIT?

- GASOLINE, for BOAT & CAR - MILES

- Miscellaneous supplies (Hardware,

- Building supply - P.O. OR CASH?

- FOOD from Supermarket Project can't afford fancy.

- Boat Tender <sup>Required</sup> needed during scuba

(SATISFIED SCUBA WORK SELF-SUSTAINED - CAN PROCEED, AT WILL, WITHOUT MY PROMISE IN HILO.)

(NETTING EXPEDITION - ~ 17-20<sup>th</sup> DEC

(CAMPING) VAN TENTS OR EARLIER - LAST DAY OF FINALS FOR STUDENTS INVOLVED

- PATCHES for zodiac

- New VALVES?

- Silicon Grease - Repetitive DIVE TABLES - COPY

FUTURE DIVE SITES: 1. SHIPMAN ESTATE

2. OPIHIKAO -

(send MAP TO MOSES CABALLERO TO ID EXACT SITE)

3. AS DISCOVERED BY

DIANE ET AL. (MOSES HILO BAY SITE?)

4. Map to Del Dykes (?)

Puhi Pt to YATCH club

- Thermometer

- Read my literature?

- YACHT CATCHING  
- Teamwork of Scuba - leadership

- Tune 35HP - Clean plugs

Permit

- Campsite at Punaluu

- Miles for Will

- Reserve van & Air flight

- Punaluu blow-up map

XEROX

- Pertinent portion of NOAA DIVE MANUAL

- Dive Flag



25 NOV. 83

Drove to Cebevi Park - backed trailer over curve and launched zodiac - those present - ① Bob Laube, ② Miles, ③ Toshi, ④ Willy, ⑤ me

DIVE ① - out channel and to the right - right off Condo - between 2 points - same as first dive when Alan and I came here in September.

In water ~ 10:45 - strong current to the east - couldn't make progress against it!

everyone back in zodiac - motored more inshore and closer to channel entrance. Drove 25-35'

depth working eastward, covering same general area covered in September. Subsequently moved 35-45' swimming back to boat (will tendie).

Miles stopped a ~ 22" turtle sleeping in a hole - it swam away and I never saw it.

Maximum depth - 50'; bottom

time ~~35~~ minutes. Boulders - lots of plankton in the water.

Came back to shore, replaced tanks, and headed back out about 2 hours later.

## DATA TO COLLECT FOR EACH DIVE:

(Willy primary responsibility - for me - but each diver should record in his/her book for their own records)

1. DATE & TIME OF DIVE
2. LOCATION - ALSO MARKED ON MAP
3. BOTTOM TIME (TIME OVER TO TIME OF START OF ASCENT); MAXIMUM DEPTH - plus range of depths surveyed
4. TIDE STAGE
5. Water conditions - VISIBILITY, CURRENT, ETC
6. HABITAT PRESENT & SURVEYED (BOULDERS, CORAL COVER, SAND, SAND CHANNELS OR PATCHES, shelf distance to drop-off)
7. Number of turtles seen, approx. sizes in SHELL LENGTH, BEHAVIOR (sleeping, swimming etc.), PRESENCE OF TAGS, INJURIES, TUMORS, OR OTHER SIGNIFICANT CHARACTERISTICS
8. Number <sup>TAGGING</sup> captured, and all relevant data as previously discussed.

25 NOV 83

Motored along the coast toward Puhii Bay - while motoring, Crow and I returned, we saw 3-4 turtles at the surface.

DIVE  
2

At east head of Puhii Bay we anchored - 3 went to east, 2 to west. Drop off very sudden and just out from where we anchored. Coral along bottom - white sand patches, cold water. Especially reported to the west - toward sewer plant. Visibility 30-40. No turtles seen.

Arrived back to shore - 2:30pm -

Visited at Walt's house 7-8:30pm.

1. Has not heard about "gear" loan from Manoa MOP
2. Not informed about efforts to register zodiac for number
3. Didn't know how to telephone me, <sup>3rd</sup> pa

WRITTEN  
NEED-SUMMARY OF ACTIVITIES  
(NEXT TO SAFETY, NOTHING IS MORE  
IMPORTANT!)

45

26 NOV of 4:30am - Met Miles, Toshi, Will  
SAT. and Bob, Chris<sup>2011</sup>, and Walt

at HCC "Boat House" at 5:30am -  
Departed for Punaluu at 6am.

Arrived ~ 7:15am. Calm seas,  
clear, light wind. Launched  
boat on ramp. Restaurant has  
been closed for ~ 1 1/2 years.

Mr. Howard is already out  
fishing. Reportedly this is the  
first good day in several weeks.

DIVE 3 start at 8:05am - MILES,  
Walt, TOSHI, me - Chris boat handler.

55 MIN  
48'

Tide coming up. Motor out channel,  
turned left and along the coast  
to off "Turtle Bay" - not too  
far before where the brown vegetation

extends close to shore. Noted  
structure on cliffs in Turtle Bay -  
Bamboo pole holder for turtles.  
Beautiful coastlines - seems well  
suited for zodiac tour.

Anchored in ~ 30' water off  
Turtle Bay. 1 Small turtle seen  
at the surface. We dove  
south, passing over wide black sand  
channels and coral encrusted  
ridges extending from shore seaward.

26 NOV  
SAT.

I saw a small turtle along one of these - possibly same as seen on Surf. Extending offshore the depth increases quickly (slopes) and becomes more barren. Relatively narrow rim of shallow along the coastline.

No other turtles seen by anyone. Returned to Puvaluku Bay, where Bob, Miles and Will brought refill bottles and returned out.

Dive 4 they made between Puvaluku and Turtle Bay, at my recommendation. Report that no turtles were seen.

They used remaining portion of bottle to Dive 5 just to the right ~~right~~ outside the channel.

3 turtles seen here. One, medium-size was sleeping in a hole. Wrestled by Miles et al but not captured. No tags on it. One of the others ~~was~~ was apparently full-size adult. A male, according to Will. Reportedly a number of pinnacles in this area - similar to off Nihoa.

When divers from 4 & 5 returned, we barbecued hamburgers and hot dogs. Food purchased by Miles. I reimbursed him \$38 - I have receipt.

note: Mr. Howard reported to Fin that  
 a few weeks ago he heard that  
 someone caught a ~~very~~ large turtle  
 with a ~~throw~~ <sup>Corvetted</sup> net right in Puraluu  
 Bay. kept it. "These guys are still  
 taking turtles -- no enforcement"

Upon arrival to Puraluu at 7am  
 a turtle right in the Bay.  
 Later Bob saw <sup>at 9am</sup> a couple in the  
 Bay again - feeding more in the  
 direction of bathhouse.

26 NOV 83

~ 60 minutes  
45' Dive 6 - me, will, walt. roshi  
(Chris boat tender) undertaken at  
~ 1 P.M. Wind only lightly up.  
Motor to the right to offshore of  
Ninole Cove. Pinnacles here, with  
cuts between rock going right up  
to shallow water & bath house.  
Drops off fast offshore, but some  
bottom relief present - not totally  
barren like off Turtle Bay in  
deep water. Shortly after entry  
an adult male was seen  
swimming - head for deep water.  
Then a juvenile was seen swimming.  
Lots of cracks, holes, and  
undercuts at bases located along  
here. Many with sand patch  
on the floor, but certainly this  
is not a requirement for a sleeping  
spot. I <sup>caught</sup> found 2 turtles  
sleeping in holes - both holes  
along side, not at base, of pinnacles.  
Do holes help protect against shark  
predation?

Both turtles taken after capture to  
zodiac - Chris motored to us.  
DATA AS FOLLOWS:

(1)  
26 NOV 83  
SATURDAY

OFF NINOLE

6714 CFC

S - 71.1 x 56.3  
(notch 70.7)

6715 C3-4th

PL - 54.8 cm

6716 RFL

HEAD - 10.2

6717 R3-4th



②

26 NOV 83  
SAT

OFF NINCE

6718 CFL

S- .69.3 x 54.3  
(no notch)

6719 L3-4th

C- 74.0 x 67.0

6720 RFL

6721 R3-4th

left postventral damaged -  
healed and  
smooth

Same data also for previous turtles -

1. Some slimy algae on carapace
2. orangish-yellow plastron - clean & bright
3. Lots of skin barnacles
4. Breath smells like aftertaste when I ate Pterocladia.

one of the above 2 turtles had the ends of both front flippers "nipped" away, but now healed.

26 NOV.

During last portion of dive I found a large female(?) was back in a dark hole. Walt didn't see it when he looked in. Like other 2, turtle did not shoot out, or be startled by my presence with it. Rather stayed still inside until pulled around.

Recall that same happened with 1 turtle Alan and I caught at Richardson that swam further back in hole - "frozen" in there. Seeking more shelter for protection(?).

With Nicole adult, I felt for tags, pulled it around, came out with it as she swam out slowly, then hung on to shell "fore and aft" while others all grabbed on.

BC helped out considerably, when inflated, as an aid to restraining the turtle. When the zodiac came along side, I put 3 tags on her in the water - her ♀  
2 pm

③

6711

No measurements taken.

6712

6713

see also p. 75

Rec. 7/9/86 EAST-N, Marilyn Major

26 NOV 83

SAT.

In the same area where this turtle was caught, Will first saw, then me, a small swimming juvenile that had 2 size 681 V tags - one on each flipper - looked to be between scales in both cases. Swam quickly - again toward deep water. Need to determine if this may have been one of the OSLP turtles released at Richardson (or elsewhere) 2 years ago. Recall that an HMB reared turtle was recovered by me here at Nihoa sleeping in a crack.

Returned to Hilo by ~ 5pm.

27 NOV. 83

SUN.

Met Miles, Will, Toshij & Bob at 12:30pm at boat house. Keel needed pumping. Traveled to Leeward Park - stopped by Yacht club. Need to ID this site on the map - also Pt. Pt.

Bernie Watson  
Hawaii

935-4877 ALICE HILO - HARBOUR DIV  
 935-5575; 9689 HAWAIIAN HOMES  
 961-7200 STATE PARKS - HILO  
 961-8311 - COUNTY PARKS

## NEEDS -

- SPARK PLUG WRENCH - SCREW DRIVER - PLUGS
- FLARE KIT
- CB
- DECENT NYLON ANCHOR LINE
- SCALE FOR WEIGHING
- BLOOD SAMPLING
- STOMACH FLUSHING

27 NOV. 83 At Molewi Pt. we saw large waves breaking where we would have to motor out. Also surfers in the area. We then drove back to the breakwater and launched the boat on the seaward side. Noted all the way out around the end of the breakwater. Miles mentioned that turtles are seen off Coconut Island. He documented a dead one washed up here - photos taken. No signs of cause of death.

DIVE

7

45 minutes

50'

on outer side of breakwater boulder I saw lots of *Pterocladia* growing. Swell washes up, especially by Blonde Reef. Swell goes right over flat times! Anchored close to shore in the calmer waters of Puhi Bay. Band of shallow ( $\approx 15-20'$ ) water is very narrow drops of the 50' - live coral and fish on slope, but dead - silt bottom at the very bottom of the slope. Followed the bottom of slope and saw a  $\approx 70$  cm turtle with tumors on eye and head swim out of a hole

27 NOV Swam on the surface, or at shallow  
SUNDAY depth, back to zodiac -

Scouted in opposite direction - towards  
Bay, following bottom of slope.  
At small outcrop into silt out from  
slope, an adult female swam  
up and quickly away as we approached.  
All along this area bordering Puki  
Bay, I saw undercuts and  
sholes suitable for sleeping.

out on a rock area near slope  
bottom Miles & I grabbed a  
turtle almost no resistance.  
Swam it back to the boat  
where we tagged, measured and  
released. Plastron and musculing is  
mildly emaciated. 2 necrotic "cracks"  
in left ventral marginals.  
Carapace had scrap and bleeding  
places - all appeared like shark  
scratches. Perhaps some were opened  
anew after we pulled it into  
boat. Data on following page:

27 NOVEMBER 1983 POTH BAY @ 45'  
 SUNDAY resting in the open near bottom  
 of slope.

6722 LFL

S - 73.3 x 57.5  
 (notch 73.2)

6723 L3-4th

C - 78.5 x 75

6724 RFL

PLASTRON - 60.5

6725 R3-4th

TAIL LENGTH - 14.5

HEAD WIDTH - 10.4

only a few skin barracks.

28 NOV 83

MONDAY

Met with Walt, Will & Diane at ~ 12 noon. at UH.  
 I need to

- 1) Register Zodiac XDC 15463 M79E
- 2) Send addressed envelopes TYPE MODEL 3269 96kg cap 2400 lbs
- 3) Repetitive dive tables - in PLASTIC
- ✓ 4) List of data to record on Scuba dives
- 5) Request data on 2 previous turtles
- 6) Resend LETTER TO COOPER'S SONS

TAGS 7528 - 7550 left at MOP

Outboard motor taken to HCC instructor -  
 Apparently throttle not opening carb. all the way.

Punchy indicated that turtles tear  
 his nets when set along breakwater.  
 Also, turtle holes exist on Blonde Reef.

Fix leaks in Zodiac - check/grease all  
 valves - especially keel.

Street - "Alumia" (Moses)

Check on Baldorodo MOP student.

Diane indicated that none of her  
 interviewers have supplied her with  
 anything.



28 NOV  
MON.

Depart 2:50 Mid Pac. FL 49  
Arrive Honolulu 4 pm.

Saw Jean Martin on plane. She now lives in Honolulu - was visiting Volcano to check on damage to her cabin. Last visited the petroglyph site in Kohala about 1 year ago.

MILES - HOME PHONE = 966-7772

( TO HILO 15 Dec Thurs. FL. 44 10:10 → 11:08. NEED EXCESS BAGGAGE  
 TO HONO 20 DEC TUES. F. 49 2:45 →

11/29 Telephone Walt at my home phone -  
 - SS to set up petty cash  
 - outboard had shot impeller - wires  
 on top melted - coils cracked.  
 #28+ for new impeller.

UH - HUMB P.O. NO. 440-608 - vendor  
 Bill to UNIV - Honolulu  
 (Requisition to follow)

ZODIAC BOAT NUMBER = HA 287 XS  
 UH-HILO  
 CENTRIFUGE?  
 Formalin

\* BASIC CRITICAL QUESTION: DO "DEVELOPMENTAL  
 HABITATS" EXIST IN WHICH SUBADULT TURTLES  
 MOVE BETWEEN AS THEY PROGRESSIVELY GROW  
 AND DEVELOP?  
 sleeping site of 20lb 2877 at Horsehoe TO 5yr 3mo  
 later 69lb caught feeding in Punahoa  
 " NEED LOCATION OF  
 " FINGERS REEF, AS PER DEL DYKES.

12/6 called Walt at home (change to HUMB)  
 12/9 called Walt " " "  
 12/14 " " "

Page 4

Duration of Dive - 40 min.

DIVE

Location - Puhi bay, Keaukaha, Hilo

Date/Time - Dec. 3, 1983, 9:45 AM

Divers - Miles Kaichi, Bob Laube, Hitoshi Ariga, Will Orcutt

Boat tenders - Lisa Hall, Sheila Mahony

Maximum depth - 60 ft

Average depth - 55 ft

Stage of tide - +3

Water conditions - Seas calm, visibility 40 ft

Habitat - Sea cliff, ledge with holes and small caves

NO. of turtles seen, size, behavior. 1) Juvenile, swimming on the surface, 30-40 cm. 2) Juvenile, swimming on the surface, ~~25~~<sup>50</sup> cm. 3) Adult, swimming on the surface, 70 cm.

NO. of turtles captured: - ~~None~~

Tag NO. Location

Juvenile, sleeping

7529 was scraped/Notused (used during Dec 15-20 Louisiana Expedition)

7528 Left

Straight length - 45.4

7530 Right

Notch length - 45.3

Width - 34.8

Curved length - 47.9

Curved width - 42.3

Plastron length - 35.2

Tail length - 8cm

head width - 7.3

Comments - This juvenile had A three prong spear <sup>where?</sup> holes, one had healed slightly, the others were still open. <sup>photos?</sup>