

go aboard landing craft again.
show pilot ARB photos
RUS about Radar Reflector.
ORDER Through canteen.

BOOK ON FLORA w/ PHOTOS.

7/31 Thurs

LANDING CRAFT AT W-S - is there a dredged channel leading in?
Was it turned over to black channel? Need details about mining.

* KENYON AND RICE AERIAL PHOTOS 1957.

SEAL REBURGATION - ^{W-S} Slipper lobster, TRIGGER FISH, LARGE SCALDS (Parrot fish?)
Greater percentage of W-S ^{TURTLE} population BASKS as compared to EAST?

Do weaned pups move between Islands? How soon? SEAL NOTES: During evening those remaining are up high in vegetation (Don't need water to cool?)
SEVERAL SEEN SHIVERING. Among pairs, male often nuzzles female when

I approach. GHOST CRAB NOTES: Particularly along Back (E) side crabs are very reluctant to enter water (Predators are?). When chased will eventually apparently enter any hole. Anyone runs down the beach and tag a turtle, but it takes patience, time and effort to tag on with disturbing it. Possibility of W Bay of W-S has been dredged - check other photos for possibility. HAS Bird feces limited

8/2 SAT

growth in large scrubbs on TRIG AND W-S? Ghost CRABS SEEM TO FEED UP HIGH ON BOTH FISH AND HATCHLING - 3 partially eaten hatchling found 8/2 AM. At 1230 proceeded to East with Joel

Whitfield - Located stumps of masts, erected and painted black marker posts. Photos taken of ground wire rings and excavated remains of main iron antenna. Oil globules noted along NE beach, on seals (also previously noted on W-S 7/31) Seal with fresh shark bite photographed. While on EAST CG whaler arrived with Hertz, ETC and BMC. Walker around island. Sunset at W-S, picked up 2 jars of globules on W-S, noted goose neck barnacles. Due to current patterns or whatever (WAVE, tide, wind?) NE shore of East, NW shore of W-S and SW shore of Trig is being seriously affected - cut into humus, vegetation zone.

8/3 SUNDAY

Proceeded to East with John and Whitfield to pick

SUN

could Mast 2 have been moved since 1949?

117

8/3 SUN up oil and take measurements. Progressing from West end of island masts are numbered 1, ② (standing), 3, 4, 5, 6 (main iron tower foundation).

Soil over hard packed coral Roadway A7 by 55gal drum - photo 8"
Mast 1 to N shore = 47'; to South shore = 214'

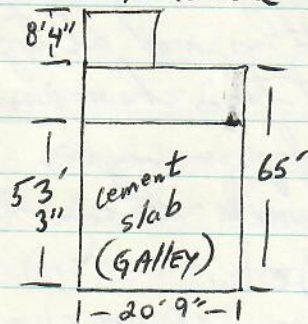

○ MAST 2
□ □ LORAN Foundations

Loran foundations = 6'7" x 3'4"

Round log = 23' x 6'

EAST Edge of slab to Mast 2 = 181'6"

Mast 2 to N shore = 44'; to S shore 161'

Mast 2 to Mast 3 = 111'; Mast 3 to S shore = 89'; to N shore = 102'

Mast 2 to Wedge of first Loran foundation = 73'; to second foundation, 85'

Mast 2 to Main 6 = 239'; Main 6 to N shore = 44'; Main 6 to S = 153'

Main 6 to Mast 4 = 61'; Mast 4 to S shore = 96'; to N shore = 96'

Mast 3 to Mast 4 = 132'6"

Mast 3 to Main 6 = 166'6" Felled Main 6 = 114'

Main 6 to Mast 5 = 242'; Mast 5 to N shore = 43'; to S = 156'

Mast 5 to end of Vegetation SNEP = ~~235~~ 235' (not on Baseline).

Mast 5 to land's end SNEP = 293'

Mast 4 to Mast 5 = 270'

Mast 1 to tent knoll = 349'

Widest NW portion of Island = 278'

EAST EDGE of slab (Galley) down Baseline to NW Wedge of island = 275' (near IRON BOAT MOORING)

Tent knoll to end of Sand point = 165'

Photos (B/K's wt) of junk, seals w/oil, picking up oil.
Note underwater machinery at Round - (3+)

See Page 117

Pole 1 to N shore = 47' + South Shore 214'

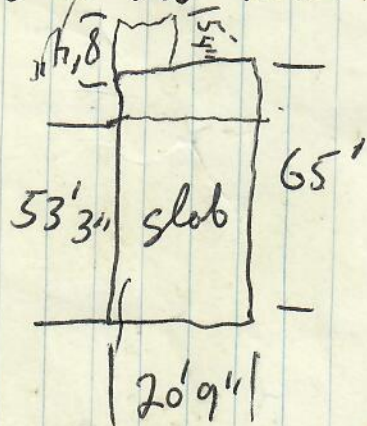

8/3/75

edge of slab to Pole 2 = 181'6''

Pole 2 to N shore = 44'; TO S shore 161'

Pole 2 to Pole 3 = 111'

Pole 3 to South = 89'; TO N = 102'

Pole 2 to edge of first foundation = 73''

TO East edge 2nd foundation 85'

6'7'' by 3'4'' foundation

Pole 2 to main 6 = 239'

main 6 to N shore = 44'

main 6 to pole 4 = 61'

~~main 6 to S shore = 153'~~

pole 4 to S shore = 96'

pole 4 to N shore = 96'

Pole 3 to Pole 4 = 132'6"

Pole 3 to main 6 = 166'6"

fell main 6 = 114'

Main to pole 5 242

Pole 5 to N = 43'

Pole 5 to S = 156'

Pole 5 to veg edge = 235'

Pole 5 to land end 293'

Pole 4 to Pole 5 = 270'

Pole 1 to Tent edge = 249'

Widest NW portion
of Island = 278'

SE edge of slab down baseline
to edge of Island = 275'

ROUND LOG 23' x 6'



7216

Check first for East
Erect vertical level
Photograph -
Take so many measurements as possible
using points on indicators.
Take down tent -
Bring blocks -
Remove all markers to water -
check roof -

Tc-22-34

AV1-3

JUNE
JULY
AUGUST

FRENCH

FRIGATE

SHOALS

1975

BALAZS

808-395-6409

BALAZS

FEBRUARY MAY 1975

EAST ISLAND MEASUREMENTS