

To- 22-34

AV1-3

JUNE

JULY

AUGUST

FRENCH

FRIGATE

SHOALS

1975

BALAZS

808-395-6409

BALAZS

FEBRUARY MAY 1975

EAST ISLAND MEASUREMENTS

copy of

copy



OUTGOING - Rollison, ED
INCOMING - C.D. Doug HERTZ

GEORGE H. BALAZS

HAWAII INSTITUTE OF MARINE BIOLOGY

P.O. BOX 1346

KANEHOE, HAWAII 96744 2/13/75 - 2/20/75 - FFS

5/1/75 - 5/8/75 - MIDWAY - pages 21-32

5/16/75 - 5/22/75 - FFS via Buttonwood

TEL. 946-1760

247-6631



NO. 1130

COMPOSITION BOOK

FAINT RULED WITH MARGIN

120 PAGES • 9½ x 7½ IN.

No. 1130-P Has Numbered Pages

S. E. & M. VERNON CO., ELIZABETH, N.J. 07208
DIV. OF THE MEAD CORPORATION

LIBRARY OF
GEORGE H. BALAZS

OMC Propeller = 379448 10 x 9 1/4

LIBRARY OF
GEORGE H. BALAZS

Narrative - 2/13/75 →

MONKSEAC TAG RECOVERIES - FEB 1975 . . . - page 5

Thursday
2/13/75

Depart FAA/HONO 8:25AM

Depart Barking Sands, Kawai 9:35AM - photos - poi pu west.

* Barking Sands Beach - Need ground and aerial surveys during nesting time - write to Base Commander for permission/reports/information. Concerning Niihau - write Robinson family directly - send testimony? Concerning Kauai - write interview old timers. Aerial survey of islands

SIERRA CLUB HUSBAND

~ 11:50 AM

	<u>Turtles</u>	<u>Seals</u>	
Disappearing Sandspit	0	48	photo
1 Gin	0	4	
Gin	0	9 (new pup)	photo
Gin	0	7	
Sandspits	0	4	
Mullet	0	4	
Round	none apparent	none apparent	
Whale Shark	2	42	
Trig	1	50	photo
Tern		3	
Shark	— NOT SURVEYED	—	
EAST	0	11	photos
Total	(3)	(182)	

Tem PM

Prepared boat, got gear together - surveyed I's
Most albatross eggs hatched - small chick - some variation in size. Buddy Ternstones, plovers(?), many red foot boobies in schools at Island end (some eggs). Some

V-notch Juvenile shells? Hack saw
HAVE small calipers made

2/13/75 Noodle Terns in Trees. N side of Island shows further erosion?
Chain on beach - Heavy fence in junk pile.

2/14/75 Launched about 9:00 AM
Motor stalled out alot - partible caught in Casparter jet? Wind out of S-SE - light wind, calm seas. Motored to Trig - Very Dry, many seals up high - middle of Island -

Seen OFF TERN
Juvenile
9:50

Birds in descending order of abundance
Black Foot; Laysan; Blue Face - (1 Christmas Is Shearwater)
w/ both eggs and young chicks of SAs

Seal Census	A	SA	P	LYP
	28	13	0	1

SA included A1036 measured 6' (72"); adult with what appears to be torn spot from tag.

2 Basking Turtles seen -

USW 747w ♂ (3 photos)
NO T prefix 74 ♂ NOT a full length tail - abnormal plate count (1 photo)

11:15 AM WHALE-SKATE

off W Cove Adult ♂ in water; 2 juveniles 1 sub Adult (E.W.)
Sea water - 24.5°

- Many Frigates - some on eggs - some on ground - same birds as TRIG
Tan along NE shore

Seals	A	SA	P	LYP
	18	33	0	5 (?)

Adults include A902; A914; A918; SA-A1097.

Do seals break Gooney Eggs? AND CRUSH chicks?

22 MAR 2002

2/14
11:15 AM
Whale skat

2 juveniles sighted - one caught ^{41.9cm} ^{38.7cm} (photos)
Tagged 57^Fin, 58cm, 58cm curved 16 1/2 x 15 1/4

Adult baskers - 4 total

AV spray paint numbers -

TC 1 ♂ LF 1/2 missing photo

TC 2 ^{sex uncertain}, curled, speckled head, RF 1/2 missing

TC 3 ♂ ^{How} short tail, RF 1/2 missing ^{Basking high} photo

4th Turtle - ♂ ^{5 sprayed} NOTC photo

TO ROUND -

Photo of glass ball and tar

Mullet - 2 Baskers

TC 4 ♂, tail 1/2 missing ^{4H 1/2 missing} 36 3/4 x 34 1/2

Seals = TC 5 ♂, only 7" tail 33 x 31 1/2

3 Adults 2 SA

3:00 PM

LITTLE GIN - narrow part of island high -

Tar along NE shore -

Colony of Black foots - approx 260 ¹⁸⁰ adults -
Few Blue face.

Seals

A	SA	P
4	5	(1)

 new w/ mother

Photo of SA w/ tar

GIN - From offshore - Few birds
+ Sandspit 3A 3SA seals

4:00

EAST - set up campsite

1 juvenile IW by boat mooring coral head -

Many BF and Laysan mixed. 1 Laysan
adult seen with 1 eye - moved head back & forth.
Many Frigates - some Blue Face.

4

22

Very Few Crab holes on any Island.

EAST cont
400PM

only 3 subadults ^{seals} Total
Tar along N shore (photo).

Juvenile off NE coral area.
Whale seen toward La Perouse - Jumping -
Blowing -
Sand point long - no sleep banks.

600PM

Flock of Terns seen circling - none on ground -
Sea Water - 23°C

SATURDAY Cool evening, some lightning, Sooty Tern
2/15/75 noises but none seen at day break.

0800AM Walked around East - no gooney bird requirit. seen.

Seal (SA) resuscitation - appears to be squid/octopus

~1000AM Juvenile Caught NE Coral patch - 17 3/4 x 16 = 40.6
Photo of head - Tagged 582F, 583, 584, 585F

1230PM

Whale-Skate
SA-A1097; A918 Tar on Belly (numerous ♀ appear pregnant)

NOA BASKER TODAY ON WHALE-SKATE

100PM

Juvenile basking at NW point - several photos
C 18 3/4 x 16 1/2 = 41.9 Tagged 586F, 588; 589 (587 lost)

Tip of Left Front missing!

230PM

TRIG - 7 Baskers on N shore

ADULT BIG TC 6 ♀ - Tail 1/2 missing; RF 1/2 missing

ADULT BIG TC 7 ♀ 1-7 backward (5) no cross on 7

BLACK (Sub adult) Turned TC 8 ♀ B/K 29 1/2 x 27 3/4 = 78.5 C1926, 927, 928

RH 1/2 (slow moving) 2 photos - 1 dorsal Left Front -

BIG ADULT TC 9 ♀

BLACK Sub ADULT? TURNED TC 10 ♂ 33 x 29 3/4; 7 1/2 Tail; C1929, 930, 931

Ventral Photo - Right eye tumor.

+ 2 ♀ adult - not sprayed

FEBRUARY 13-20, EXPEDITION
SEAL TAGS

<u>DATE</u>	<u>ISLAND</u>	<u>STAGE</u>	<u>TAG NO.</u>	<u>LENGTH</u>
2/14/75	TRIG	SA	A1036	72"
"	WS	A	A902	—
"	WS	A	A914	—
"	WS	SA	A918	—
"	WS	SA	A1097	—
2/15	WS	SA	A1097	
"	WS	SA	A918	Tom on belly
2/16	WS	SA	212	need scar photos 76"
2/17	WS	SA	1043	69"
"	WS	(SA)	A672	73"
2/18	WS	SA	A1098♀	70"
2/18	WS	(A)	914	75"
2/18	TRIG	SA	A1097	70"
2/18	TRIG	A	A796	83"
2/19	W-S	SA	212	

growth?

Seal Tags (cont.)

"74"	PIP	A	210
"75"	PIP	A	210
"76"	PIP	A	210
"77"	PIP	A	210
"78"	PIP	A	210
"79"	PIP	A	210
"80"	PIP	A	210
"81"	PIP	A	210
"82"	PIP	A	210
"83"	PIP	A	210
"84"	PIP	A	210
"85"	PIP	A	210
"86"	PIP	A	210
"87"	PIP	A	210
"88"	PIP	A	210
"89"	PIP	A	210
"90"	PIP	A	210
"91"	PIP	A	210
"92"	PIP	A	210
"93"	PIP	A	210
"94"	PIP	A	210
"95"	PIP	A	210
"96"	PIP	A	210
"97"	PIP	A	210
"98"	PIP	A	210
"99"	PIP	A	210
"00"	PIP	A	210

NEED: Needed - New Flashlites (Head lamps) Propane fuel
 Steering part for motor EXTRA HATS
 Bailing wire Small Scale 22 MAR 2002
 WD-40 cutter key - Shear pin
 Motor splitters at low speeds. Rustoleum spray paint

Saturday
 2/15/75

TERN IS. 2/14 evening

4:00 PM Juvenile found at old aircraft parking beach -
 on shore - bleeding bad, still at same site,
 Tugged and transported to EAST and released -
 still very strong - $18\frac{1}{2} \times 17\frac{1}{2}$ - 590; 591; 592
 SHARK BITE BY TAIL

6:30 PM East Sea Water 24°C - Air 65° & 80°F

9:00 PM Sooty Terns hovering over island -

NOTES - all juveniles seen are brown colored w/ gold shell -
 none appear similar to captured greens, even
 though they were obtained FFS.

High basking usage of Trig and W-5 could be
 due to proximity to open ocean - outer reef
 Two choices for brown juveniles - hatched here
 never left; Migrated here - after being hatched
 here and leaving for hatched elsewhere.

SUNDAY

2/16/75

Morning Censused albatross chicks - East (maybe 10% under)

East U	First quarter from Tent -	BF - 217	LAY - 42
Seals - 4A	Center section -	BF - 205	LAY - 125
6SA	Angled log to SNEP -	BF - 450	LAY - 204
247P	Total:	872	371

1243

Several dead chicks noted - size
 - range approx newly hatched to

10:30 AM Juvenile East NE Coral - $C17 \times 16$ - 593; 594; 595; 596
 5 postoculars on left

1:00 PM

Mullet

also TC 5 basking (7 tail ♂) CI 932
 NO TC ♂

small increases in length over a certain size produce
large mass increases.

TURTLE TAGGING

Date	TAGS	SEX	LENGTH x WIDTH	Location
2/14/75	579 ^F , 580 ^F , 581 ^m	?	C 16 1/2 x 15 1/4 = 38.7	W-S westside
2/15	582 ^F , 583 ^F , 584 ^m , 585 ^F	?	C 17 3/4 x 16 = 40.6	East
2/15	586 ^F , 588 ^F , 589 ^m	?	C 18 3/4 x 16 1/2 = 41.9	W-S West Bay
2/15	926, 927, 928	♀ TC8	C 29 1/2 x 27 3/4 = 70.5	TRIG
2/15	929, 930 ^F , 931	♂ TC10	C 33 x 29 3/4 = 75.6	TRIG
2/15	590, 591, 592	?	C 18 1/2 x 17 1/2 = 44.5	Teln - shark bite
2/16	593 ^{LF} , 594, 595, 596 ^{RF}	?	C 17 x 16 = 40.6	East
2/16	932 ^{LF} ♂ TC5	6 1/2 tail	C 33 x 31 1/2 = 80.0	Mullet
2/16	597, 598, 599 ^{RF}	?	C 20 x 18 = 45.7	W-S W Bay
2/16	933 ^{RF} ♂ TC1			NE W-S
2/17	442 ^{RF} , 502, 503	?	C 17 x 16 = 43.2	W-S W Bay
2/17	934 ^{RF} ♀ TC11		C 38 1/2 x 36 = 91.4	W-S E side of camp
2/17	935 ^{RF} ♂ TC12		34 1/2 x 32 1/2 = 82.6	NE W-S
2/17	937, 938 ^{RF} , 939	♂ TC14	C 32 3/4 x 28 1/2 = 72.4	NE W-S
2/17	504, 505, 506 ^{RF}	?	C 17 x 15 = 43.2	W-S west Bay
2/17	507, 508, 509 ^{RF}		C 15 3/4 x 14 = 40.0	W-S west Bay
2/17	940 ^{RF} ♂	NOTE	C 34 x 31 3/4 = 80.4	NE point
2/17	941 ^{RF} ♀	NOTE	C 33 3/4 x 33 = 85.7	W-S TRIG-N
2/17	942, 943 ^{RF} , 944	♀ TC16		TRIG-N
2/17	945 ^{RF} , 946, 947	♀ TC18	C 32 1/2 x 31 1/2 = 82.6	TRIG-N
2/17	936 ^{RF} ♂	TC13	C 35 3/4 x 32 1/4 = 90.8	NE W-S
2/18	948 ^{RF} ♂	TC	C 34 3/4 x 30 1/2 = 88.3	W-S N West Point
2/18	510 ^{RF} , 511, 512	?	C 19 3/4 x 17 3/4 = 50.2	WS
2/18	949 ^{LF} ♀	TC19	C 34 x 32 = 86.4	WS NE
2/18	950 ^{RF} ♀	TC20	C 34 x 32 1/2 = 86.4	TRIG
2/18	951 ^{RF} ♀	TC21	C 35 3/4 x 35 = 90.8	TRIG
2/18	952 ^{RF} ♂	TC22	C 39 1/2 x 33 1/2 = 100.3	TRIG
2/18	953 ^{RF} , 954, 955	♂ TC23	C 35 x 32 1/2 = 88.9	TRIG
2/19	956, 957, 958	♂ NOTE Assigned	C 35 1/2 x 33 = 90.2	W-S NE

Date	TAGS	SEX	Length x width	Location
2/19/75	959, 960, 961	♂ TC 3	C 33 x 31	W-S / NES shore
2/19	513, 514, 515	RF ?	C 17 1/2 x 15 3/4	East
2/19	516, 517, 518	RF ?	C 15 1/4 x 14 1/4	East
2/19	962	♀	C 33 1/2 x 32 3/4	Trig
2/19	963	♀	C 38 x 39 1/4	Trig
2/19	964	♀	C 36 x 35 1/4	Trig
2/19	965	♀	C 34 1/4 x 34	Trig
2/14	Previous USW 747	♂ TC 17	C 34 x 34	TRIG
2/14	Prev 74	♂	not a full length tail	ABNORMAL PLATE COUNT

Previous or Original Data

Tag	Date	Sex	Length x width	Weight	Location	Tagged at
T22	5/5/72	♀	C 38 1/2 x 40 1/4	280 lbs	Trig	1/2 HR MISSIN
747 USW	6/14/68	♂			East	
	10/15/73	♂			Trig	
473 USW	3/14/67	♀	C 34 x 32 3/4		TRIG	
74	8/29/65	♀	C 31 x 28		TRIG	By A. B. Ame

ON Cards - 18 ♀, 15 ♂

Sunday
2/16 cont.
MOVED TENT
TO W-5
2/16 early PM

1 sub-adult (♀) seen in water off EAST -
Also 1 juvenile Blackish unlike all others thus far.
Whale-Skate juvenile caught from boat -
C 20 x 18 ^{50.8} 597, 598, 599^{RF}

clean shell - reddish brown color.

TC1 basking (NE) shore^{RF} tagged 933^{RF}
WHALE-SKATE

500 PM
↓
VISITED TRIG -
NO BASKERS

Seal census -
A-8 SA-21 of these LYP-3
Seal (A) tag 212 head scan - fat - ^{photos} Blk's wt & color
Measured - 76"

2/17 - Whale-Skate

MONDAY - Few seals hauled out during morning 7:30-10 AM
juvenile C 17 x 16 ^{43.2} 442^{RF}, 502, 503^{RF} - PINK CORAL
Blk. spots on head - photo

10:30 AM

Baskers first observed starting to haul out - Trig and Whale-Skate must be desirable due (to proximity to outer reef - also for seals?)

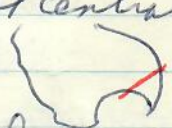
TC 11 (by log) photo #8 on roll of 20. C 1934^{RF}
♀ C 38 1/2 x 36 ^{97.8} fat central
turned down - right hind → 

12 NOON

Several Baskers at N/E site - photos taken using Telephoto - as follows

before TCing photos
↓

- ① #9 kill of 20 ♂ (curled shell on one side)
- ② ♀
- ③ 2 ♂ together near water
- ④ ~~the~~ Small turtle waters edge (subadult size?)

12

MONDAY

2/17

1200 Noon

TC 12 ♂ CI 935^{RF} not cinched properlyTC 13 ♂ CI 936^{RF}TC 14 ♂ Turned C 32^{3/4} x 28^{1/2} ^{83.2} ^{72.4}
CI 937, 938^{RF}, 939
photo of claws and tail (2 photos)check
photo

100PM

TC 12, TC 13 and NOTC seen offshore
going in circles for long periods -
some attempts to mount, but not
certain who. TC 1 present for a while
but soon hauled out (because of missing
flippers?)

130

Juvenile - C 17 x 15 ^{83.2} ^{38.1}
504, 505, 506^{RF} pink coralJuvenile - C 15^{3/4} x 14 ^{40.0} ^{35.0} 507, 508, 509^{RF}
Blackish head and dorsal limbs - photos

Tried to bite several times.

200PM

Whale Skate NE Point

NOT splayed ♂ C 34 x 31^{3/4} CI 940^{RF} ^{80.4} ^{80.6}

Tail 1/2 missing - internal structure partially out.

W-5 Seal Census - A-19 SA-32^{These} LYP-5

of SA 1043 (69"); A672 (73")

A- ♀ (83"); ♀ (93"); ♀ (94") ♂ (93")

Differentiate between age groups - Sexually mature adults
- vs - Adult category (subjetive).

MONDAY
2/17/75 TRig - Sand Island, noted to NY -
330 Several seals hauled out.
Baskers on Trig -

- TC 15 Big ♀ not able to tag ^{85.7} ^{83.8}
- Not able to TC ^{RF} CI 941 C 33 3/4 X 33
- TC 16 ♀ Turned ^{not able to measure} 942, 943 ^{RF} 944
- TC 17 ♂ U.S. Wildlife Hono USA 747 ^{RF} C 34 X 34 ^{86.4} ^{86.4}

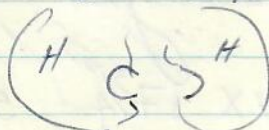

- crawled on top ^{82.0} ^{80.0}
- TC 18 ♀ C 32 1/2 X 31 1/2 945 ^{RF}, 946, 947

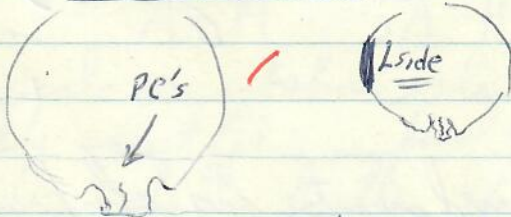

SEAL
NIGHT
CENSUS

2300 1100 PM

To Tern for dinner and return to whale-skate.
Today's air temperatures - 70°F and 82°F.

Seal census -

A - 5 (4 pregnant) SA - 3

Sooty Terns on ground - NE end, also few nodies.

2/18

TUESDAY WHALE-SKATE

930 AM - NOTC hauled out, laying beside seal - many photos
ALBATROSS chick counts -

ST to Tent	BF - 429	LAY - 45
Tent to NE	BF + 226	LAY - 24
Total	655	69
	724	

color of
B/K i/wt
few still on eggs
few dead
several with
bloody necks
some BF w/ white tails

Tues-cont TC 1, 3(?) and 13 basking along NE shore.
2/18

1200 Noon TC sprayed spot (wetshell) ^{Right side} C 34 3/4 x 30 1/2
CI 948 ^{RF}

Nwest point
- TC 1, 3 and 13 basking W-S (NE)

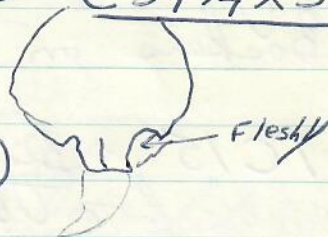

Seal A1098 ♀ 70"-71" -
nose ^{FAT} near SA hauled out by tent -

Juvenile (W-S) C 19 3/4 x 17 3/4 510 ^{RF}, 511, 512
Photos taken w/me

TC 19 ♀ (turtle by seal) C 34 x 32 949 ^{LF}
RHIND

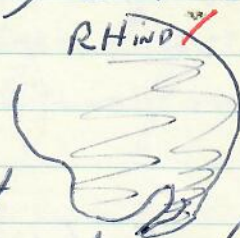

male observed mounting for short periods and attempting to mount male.
TC 13 measured - C 35 3/4 x 32 1/4

Seal 914 - 75"

all photos of turtles w/tele on 2nd Roll 36 EX 11 #

330 PM

TRIG - Seal A1097 - 70"
A796 - 83"



TC 8 basking - N side, sand point end. 920
TC 20 ♀ C 19 5/8 ^{RF} C 34 x 32 1/2 Photo - Flatfish on 2nd 36 Roll 9

NOTE ♀ Medium size tumors on dorsal surface of Both Hind Flippers
TC 21 ♀ C 19 5/8 ^{RF} C 35 3/4 x 35 - Thick photo

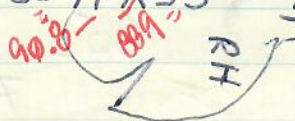

TRIG -
2/18

photo - side view

Make cards
for all TCS -

on those w/ measurements/sex

15

TC 22 ♂ but tail not full size, - small both
in length and girth. C $39\frac{1}{2}$ x $33\frac{1}{2}$
952 RF → cinched but close to tailing edge.
WHALE-SKATE - NE shore

TC 23 ♂ Tail 1/2 missing - internal structure partially out.
C 35 x $32\frac{1}{2}$ - 82.6 - TURNED 953 RF, 954, 955



Trig Seal Count - A-19 ← 1 w/ 1/2 missing tip (previous photo)
SA-15 LYP-1
Several seals on offshore island to NW.
Island very dry except for a number of Seacola.
Sand point now extends further to E. Seal Is.
not there.

Bird Count - BF - 74

LAY - 11

Total - 85

Note: albatross chicks dig depression -
For Temperature? wind protection? OR crushing
from seals?

600 PM

Sea water 24°C

air - 69° low 81° high

Small shark may have been responsible
for few juvenile sightings by W-5 today.

Light calipers needed - large & small pair.
 BIK; wt aerials needed of basking areas on each Island.

Notes - juveniles have tail-kind flippers up in air - while feeding (?)

Problem of not reporting tagged turtles captured.

Group basking by seals?

are lengths of what appear to be mature females significantly less than breeding season animals?

Specific site selection for basking - why?

Check records for number of baskers during Sept-Oct visit.

How long will high basking numbers on Trig-whale skate persist? Jan-Feb-? Need Diving Survey of outer Reef AREA - OR low level Aerial in small plane.

POSSIBILITIES OF WHY BASKERS ARE NOW PRESENT

1. PRESENT (RESIDENT) ALL ALONG AND ONLY NOW (THIS TIME OF YEAR) DECIDED TO BASK;
2. EARLY MIGRATORS INTO ATOLL FOR 1975 BREEDING/NESTING SEASON;
3. MIGRATING FROM ONE SITE TO ANOTHER AND ONLY STOPPED OFF FOR SHORT-TERM BASKING BEFORE RESUMING TRAVELS

Thig Animals this date exhibit group basking/however no direct contact, P7

WEDNESDAY WHALE-SKATE
2/19/75 ~9:30AM

NW point ♂ Tagged 956, 957, 958
C 35 1/2 x 33 = 83.8

NE shore C 33 x 31 = 83.8, 78.7 ♂ TC 3-959^{LF}, 960, 961

>12 NOON

East Island

① juvenile C 17 1/2 x 15 3/4 = 44.4, 40.0 513, 514, 515^{RF}
Laminae split in lateral - 2nd R

② C 15 1/4 x 14 1/4 = 30.2 516, 517, 518^{RF}

Both juveniles have blk on head - dorsal lips.
Photos of plaster - smaller dorsal shot.

>300

Round - TC 5 Already recorded - note sampling
C 33 1/4 x 32 = 84.5, 81.3, 76.5
6 1/2" Tail - 16.5
small diameter

TRIG ISLAND

11 baskers total

① steep carapace ♀ C 33 1/2 x 32 3/4 = 55.1, 53.2 C 1962^{RF}

② ♂ adult full size - depart

③ TC 21

④ TC unreadable ♀ 96.5, 100.1

⑤ ♀ C 1963^{RF} C 38 x 39 3/4

Previous T22 BUREAU

1/2 LH 5 ← Almost completely missing Front R 1/2 missing

⑥ ♀ C 1964^{RF}

⑦ ♀ depart - no tags

⑧ ♀ Previous U.S.W. 473^{RF} C 36 x 35 1/4 = 91.4, 89.5 NO CITAG

Goldfish - Photo when first emerging.

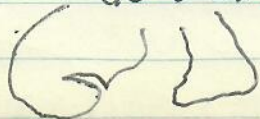

Light Bolts + many photos

Group of 4

CMC

NOTES: APPARENT FACTS FROM FEBRUARY VISIT -

1. Most all BASKING TAKES PLACE ON TRIG/W-S,
NONE OR LITTLE ON EAST, GIN, L. GIN.
- Must still CONFIRM STATUS OF SHARK
2. AT LEAST TWO SUB-ADULTS WERE
TAGGED/OBSERVED - ~~THIS~~ ^{THIS SIZE} NOT SEEN DURING SUMMER.
3. SEVERAL LARGE SIZE MALES SEEN WITH
LESS THAN MATURE SIZE TAIL
4. STILL NO WILDLIFE ACTIVITY ON TERNS BEACH.
5. JUVENILE POPULATION IS EQUAL TO OR
LARGER THAN SUMMER.
6. PIGMENTATION MAY CHANGE FROM BLACK
TO BROWN/GOLDISH AT ~12" IN AT
LEAST SOME OF THE JUVENILES
(DOES IT AGAIN CHANGE BACK AT A
LARGER SIZE - NOTE 7016 W-S CAPTURE?)
7. NO RECAPTURES OF JUVENILES CAUGHT DURING SUMMER 1973.

TR
CON
WED
2/19

6:30

700
THURSDA
2/20

TRIG
CONT

RELEASE ETCHED GLASS BALLS
DURING HATCHING MONTH.

19

WED
2/19

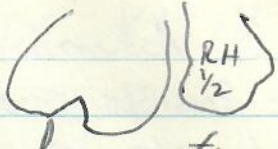
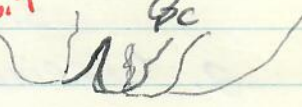
- ⑨ ♀ 36x34 no tag 
- ⑩ ♂ horny tail - dried wound no tag
- ⑪ ♀ CI 965^{RF} C 34 1/4 x 34 ^{87.0} ^{86.4} 

Whale-Skate - west Bay 25°C East-25.3°C

TC 12 Basking - C 34 1/2 x 32 1/2

air 70°F and 83°F

photo of pregnant seal w/scar I ^{head scar} 212

6:30pm - Broke camp - disassembled gear -
motored to Shark - swirl SW swell -
seals on Island - unable to land.
Pulled out boat.

700
Thursday
2/20

BF - 212 CA7-110

Censused albatross on Tern
Depart ~ 1:30 - Take off top West -
photos of Tern/Whale Skate.

Photo of Fairy Tern in Flight.

^{PILOT} Alex indicated that she was
on ship in 1942 that hauled
on East Island to destroy food/water
supplies in case of Japanese takeover.
- This was prior to Tern Is construction
month - April. Service - NAVY - AUDIO U.S.S. Ballard

Joel taking sea water temperatures twice weekly.

GOONEY BIRD CEPHALOPOD SAMPLE COLLECTED FOR I.D.

ASSUMING THEY WERE DERIVED FROM FFS HATCHLINGS -

NOTES: POSSIBLE SOURCES OF JUVENILES PRESENT IN ATOLL:

1. NEVER LEFT ATOLL - GREW TO THAT SIZE AS RESIDENTS -
2. CARRIED TO WEST AS HATCHLINGS - GREW AND MIGRATED BACK. THIS EXPLANATION COULD INCLUDE VARIOUS DISTANCES TRAVELED TO WEST (OR NORTH LOOP, - SEE BARKLEY) EXTENDING ALL THE WAY TO MIDWAY - IS A JUVENILE THIS SIZE CAPABLE OF TRAVELING THIS FAR? - SEE REFERENCES.

WHAT IS SIZE OF JUVENILES AT MIDWAY (ALSO COLOR)?

DO FFS / JUVENILES ONLY REPRESENT SOME SMALLER ABERRANT PORTION OF THE TOTAL? SUCH AS IN TWO "KINDS" OF GREEN TURTLES?

IS IT POSSIBLE THAT ^{FFS} JUVENILES ARE DERIVED FROM THOSE HATCHLINGS THAT ENTER WATER DURING MONTH THAT CURRENTS FORM "LOOP" TO NORTH AND RETURN TO SHOALS AFTER A PERIOD OF TIME? ALL OTHER HATCHLING GET CARRIED ON TO WEST AS CURRENTS EXIST. DRIFT BOTTLE STUDIES WOULD BE IMPORTANT - SEE WHAT TYPES ARE USED AND AVAILABLE.

INVESTIGATE tail length/shape of wild vs CI captive reared juveniles.

May 17
Thursday

Abundant
Aug or Sept

MIDWAY ISLANDS VISIT

May 1, 75 Depart MIDWAY - Hickam AFB 7:45 AM C/41
 Thursday Fl. time 3:25

Notes - save old tags -

Heavier wt. per unit length than FFS juveniles?

→ Sleep-side manifests at 35-40 lbs (18-20" SL)?

→ Need size distribution bar graph for Midway captures.

→ or Midway juveniles are ^{doubt} wide (straight)? Need Ratio.

Need plotting of wt vs length.

Need mean, range, S.D. - appear to be heavier than 7kg = 15.4 lb (common "goodward")

Migration paper - consider aerial, etc surveys.

ABundant
 Aug or SEPT, Hawaii

April 20, 75 star-bulletin article on Refuge Islands -

↳ Manowar (?) on beach - abundant
 whereas juvenile caught (?)

New data sheet for turtles - (w area) color - ^{Fixation} REMARKS -

Walked all the way around Sand Is. -

saw juvenile, S of Picket Pt -

Birds include Bonin Petrel, Laysan, few Blk ft, Noody, Fairy, cowbirds -

Saw juvenile inside deepwater harbor
 platform on N reef used by National Geographic?

MAY 2, 75 on Eastern Is. all day, Drove two sites, saw 3 turtles from shore (1 ~ 24"), saw one small in water. West end dense algae in places, found Codium on shore - Tim (317 green barack) ^{Kurishima}. Lots of junk on shore Photos ~ 19-32, 1st roll Eastern Is.

Saturday
May 3, 1975

Visited Koyl Kings Dive club - walked around ^{sand} Is. - dove by picket point, saw 1 turtle. Freed albatros from barbed wire, saw dead chicks inside -

Mr. Rossiter (civ), here for many years - took 90 turtles (Contact Tennyson 1RO or Cmdr Wilson for address -

Diver KK - ^{large turtle outside reef} Jay
Curt Harey; MacFarland "Mac"
Bird kills - ~ 66 February with knife in tree
1 year ago - with club

Recently at NavFac - 20 dead
April 27th - bang stick - punishment =

"Bird abatement" "Refuge Signs"

Turtle spear - executive officer - NO MAST - NO PUNISHMENT

NAVY - U.S. Fish Wildlife agreement

Naval Wildlife information - SOPAMIDWAY ^{11015.1} Inst.

Subscription to - "The Islander" -

Go to Pearl and Hermes Reef 2x year, once just before July 1st for balls for ruffle.

Run over chicks with trucks -

Hit adults - many adults hit wire during first arrival -

Fumigate - move eggs.

Black MAIL FISH
AND WILDLIFE SERVICE!

Note: write letter to Fisher, Harvey I.

Department of Zoology and
School of Medicine
Southern Illinois University
Carbondale, Ill. - 62901

No Barnacles ^{or Algae} on Midway Turtles (?)

Saturday
May 3, 75 "Mac" spent 2 weeks at Kure, reports more turtles than at Midway - CG take lobsters. RR at Kure ^{NAVY} Friday - Monday.

Need - several "tagging" kits
B/K & wt photos (of proper tagging methods in Plastic) -

Numbering on KK chart 100-113 through 800-813.

CG catching turtles at Midway? -

Midway Monthly range seawater temperature?

Turtles eating Portuguese man-o-war - ^{many saw them}

Security continually picks up ^{dead} birds -

Sunday
May 4

Dove NAVFAC beach, more coral out by reef. Captured one flipper turtle (Rightonly) by coral head

Straight 16 1/8 ^{4.0} x 13 1/2 ^{34.3}

Curved 17 1/4 ^{43.8} x 16 ^{40.6}

Thick 6 1/2 ^{16.5}

Plastron L - 13 ^{33.0}

Weight - 21 1/4 lbs

Tail - 13 1/4 ^{4.4}

Blackish photos

ON DATA sheet

Tagged two later in day, 1 - some Blackish; 1 - gold w/ light tag nos 1551^F; 1552^F at 1453; 1454^F TAG - 1528^{RF}

by Hines Caught 5 shags of Eastern w/ 5 others present (1 large). Tim Kurishima and ELE state they have never seen Codium at Midway. ^{surf board found from Hawaii}

Jim Bradley neighbor Helicopter mechanic never seen large turtles while fishing outer reef - check with chopper pilots.

Blk and wts of Birds and Tag procedure
oil leak?

Predation on eggs and chicks by rats(?)

<1936 NO RATS

Annual May meeting on Midway "Wildlife conservation"

Sun
May 4

MIDWAY ISLANDS F.C. Hadden

The Hawaiian Planters' Record

V XLV N 3 1941 p 179-221

copyright Hawaiian Sugar Planters Ass.

lists bird species and abundance during
earlier years - ON SAND IS.

QHIN219

ALBATROSS article - by ASHMOLE

NAT. HIST. BULL.

YALE UNIV. 24: 1-131

QW671 L57

LAYSAN ALBATROSS 1971 The LIVING BIRD p 19-78

Sun
May 4 cont. Library references -

The wreck of the Soginaw - Keith Robertson 1954

Vail-Ballou Press Inc 144p

The Albatross of Midway Island - Mildred L. Fisher

S. Illinois Univ Press 156p

Midway's Deadly Antennas - Harvey I. Fisher

Audubon, July - Aug 1966

also related articles in

* May-June 1964 and Jan/Feb 1958

Birds and Aircraft on Midway Island 1956-7

Investigation - Special Scientific

Report - Wildlife No. 38 USFWS

Birds and Aircraft on Midway 1959-63 INV
NO. 85

Airplane - Albatross Collisions on Midway

Atoll H.I. Fisher V 68 N 3 May-June 1966

p 229-242 The CONDOR

The Death of Midway's Antennas - Fisher

Jan 1970 Audubon

The Visits of Laysan Albatrosses to the

Breeding Colony - Fisher and Fisher

MICRONESICAE 5 (1): 173-221 1969 July

Oceanic Distribution of the Laysan Albatross

Fisher and Fisher The Wilson Bulletin V 84

- N 1 March 1972 p 7-27.

Experiments on Homing in Laysan Albatross - Fisher

The Condor V 73 N 4 1971 p 389-400

Sympathy of Laysan and Bk Footed Albatross - Fisher

V 89 No. April 13, 1972 p 381-402

Laysan & Bk F A B Alfred M. Bailey - Museum Pic N 6 Denver

D.G. Bennett

P.L. Bruner

D. Pratt

- 15-30 MAY

continue ecological studies
of albatrossMONDAY
MAY 5,

officer Kennedy - Harbor Master

July 1, 1972

AGREEMENT FOR THE CONSERVATION AND DEVELOPMENT
OF FISH AND WILDLIFE (Cooperative Agreement -
Midway Appendix A)

... jointly completed... - at the earliest
practical time, a general inventory review of fish and
wildlife resources presently existing on Installation -

- * \ (a) locate principal land and water areas suitable for fish & wildlife.
- * \ (b) list the principal species of wildlife, conditions of their range, and a census of population.
- (c) Describe water areas as to location, type, and acreage with principal fish species known to be present and observations on the quality of the aquatic habitat.
- (d) Define the areas that necessarily are restricted and those areas suitable and available for use under this agreement.
- (e) outline a long range general program with a detailed 5-year plan of the immediate objectives and potential for fish and wildlife resources.
- (f) This plan will be reviewed annually.

TUESDAY
MAY 6,MAY 7,
Wednesday

MONDAY

MAY 5, 75 HComdr Lyke Branch - Found 20 dead at NAVFAC - already ~ 1 wk old.

Fence behind CPO club - catches chicks learning to fly.

Break new eggs along side runway - over past year ~ 12 albatross incidents
oil leak present

Wild bloated turtle reported by Mr. Warren -

Looked for short-tailed albatross - visited at Coral Kings -

TUESDAY

MAY 6, 75

Dove off S. shore of Eastern Is. sighted 4 turtles, 2 with head in coral overhang, 2 head out -

Caught 2 in - Data on sheets → 1455^{RF}; 1458 - PL - 13 1/4" = 33.7 CL 17 3/4 x 16 = 45.1 = 40.6
Tail 1" = 2.5 - Gold color - Photo

1459^{RF}; 1460 PL 13 1/4 = 33.7 CL 17 1/8 x 15 3/4 = 43.5 = 40.9
Tail 1" = 2.5 Bk head, upper limbs - some gold on shell.

"all not comparable due to different measurement sites.

Dove off Reef Hotel - found glass float on reef platform, abundant coral growth, many species fish, also visited Spit Island -

Trail of approx. 3 seal maximum.

MAY 7, 75 -

Wednesday Dove at Eastern all day - Tagged 3 turtles - Saw many others -

Turtle speared by civilian at NAVFAC
TAD - Temporary additional duty - person not aware of wild life regulations:

Eastern Is a total land and marine Refuge -
Tear up runway -

TAG NUMBERS LEFT AT MIDWAY -

Size 681 - 1468-1500 1529-1600

Lt. Nolten

most he can give
for Captain's Mast

Request 10-15 slides for
school lectures -
also possibility of writing
letter stating value of my
coming.

Capt. Hersch
5 min on TV
MAY 5 Tues 6PM

Fine for "bang stick" killing - 45 days
extra duty (90 hours work) : \$390 fine ;
Reduction in rate but suspended for
6 months.

- Reason for not sending to Hono ① New on Island
- ② Strong support from Division officer ③
- ④ Less fine in Federal Court.

Jim Bradley's neighbor's name - ^{Mr.} Warren

Need - Gosh's flavoring -
Ask about - under water turtle photos -
also Bradley photos on Refuge trip -

CONTINUED
May 7

knifed and hung
by Capt. House
(No Re...
fill)

" Hypocrisy
WINDOW DRESSING

MAY 8
Thurs

CONTINUED
May 7, 75

Gave talk to Koral Kings in evening.
Captain Kersch "cornered" on TV at 1 PM - questions - "why not sent to Federal Court?" - Punishment would have been less.
"\$50 per albatross - but not for other birds." Ship Albert Meyer gave \$100 to fund - "like to see albatross at sea".

Gary Means - Biology Teacher, George Cannon School

H.J.B. Bob Lancaster NAVFAC (Boston leg)
- Possibility of Albatross photo.

Steve Kimura - Pacific Missile Range
Informed that ~ 8 bills over last 12 months involving 250 birds.
2 weeks ago - ~ 20-40 birds fresh kill (chicks).

knifed and hung
By Capt. House
scared wife
No Response
Kill this

" Hypocrisy
WINDOW DRESSING "

Report the 3 TUNA boats will be coming this weekend to Fish Local Waters.

arrived MAY 8 - VIVA - Mono BAY
- after ALBACORE JINITA - Long BEACH
TRAILING (TRAPS ABOARD) Typhoon - Astoria

oil spill at Dock - photo - emulsified from leak (?)

Go to Pi'H for Fish Balls in June - Break eggs on runway - also ~~by one not used~~ - 3-4000?
Fence behind CPO club for chips -
Chart in office showing aircraft strikes -

MAY 8
Thursday - Depart for HONO C141

Midway → Honolulu
 Lisianski 12:53 PM Rtside 66 NM
 Laysan 1:18 PM Rtside 36 NM
 FFS 2:04 PM Rtside 30 NM

Midway Project Proposal Notes:

In cooperation with U.S.F.W. -

- Consistent with Wildlife agreement -
- Endangered status of animals -
- Integral part of Archipelago picture / turtles life cycle -
- Value to Midway school -
- Moral value to Dive club -
- Two, possibly three, visits per year - 1 week each -
- Transportation, Expenses -
- In connection with Kure supply - Coast Guard Tender to Kure -
- address and/or forms - office of Naval Research (NOR?)

DD Declaration Form 1854
 "Wild Bird Feathers"

Tuesday
 MAY 1
 220
 Wednesday
 MAY 14
 09
 140

1900

Midway Data Sheets -

all w/ tape
 measure

Curved (length, width; carapace) length plastron, Tail from plastron

* Weight ?

Tag Numbers (1 for flipper)

* Straight carapace measurements

* Sewel - Replace old tags

Area Taken / Released

Predominant ^{limb} color / ^{shell} injuries / Remarks

* Name of tagger

* HMB in cooperation w/ USFW

*

Tuesday
 MAY 13, 75
 2200
 Wed-

USCGC
 BUTTWOOD -
 Depart for FFS 26 captive turtles
 aboard -

MAY 14, 75
 0900
 1400

OFF Kauai

Post Niihau - good seas - partly cloudy
 notes - Data book pages comparable to individual
 cards on each animal, e.g. - Date, Time,
 area (location), Status^(sex), observations (pits, abnormalities,
 coloration, lay,) TC#, CI#, sex, FGG counts

Remarks,
 checked turtles -

TAGS present
 upon Release RF

1900h

(Port crate)
 immunized X

ON
 CARD
 10/6/75

- ① 363m OFF
 ② 398, 449 OFF
 ③
 ④ 121 OFF
 ⑤
 ⑥ No Notches 387 OFF
 ⑦
 ⑧ LH 1/2 miss 397 OFF
 ⑨ 129 OFF
 ⑩

1601 LFlap, 1602
 1410^{LF}
 362, 1524^{LF}, 1523 RFlap
 1532^{LF}, 1603 RFlap
 1446^{RF}, 1522 LFlap
 150, 1604^{LF}
 1401 RFlap, 1402^{LF}
 1605^{RF}, 1606 LFlap
 1412 RFlap, 1413^{LF}
 1435^{RF}, 350

center crate (NOT IMMUNIZED)

- X ①
 X ② 482, 1417 OFF
 X ③ 365 OFF
 X ④ 337, 467 OFF
 X ⑤

1430^{RF}, 112, 352
 1419 LFlap, 1607^{RF}
 125, 1422 RFlap, 1423^{LF}
 1608 LFlap
 1407 LFlap, 1408^{RF}

Thursday
May 15

stbird. crate - X ① RH 1/2 miss
immunized

- X ① 340 OFF 1420 RElap 142 LF
- X ② 380 OFF 1609^{RF}, 1610 LFlap
- X ③ 475 off 1460 OFF 360, 1611^{RF}, 1612^{LF}
- X ④ 338, 472 OFF 1431^{RF}, 1613 LFlap
- X ⑤ 373 OFF 464 OFF 1437^{LF}, 1614 RFlap
- X ⑥ 1405 RFlap, 1406^{LF}
- X ⑦ 395 OFF 133, 1415 RElap, 1416^{LF}
- X + ⑧ 344 OFF 1442^{LF}, 1615
- X + ⑨ 302, 478 OFF 1414^{LF}, 1616 Rflap
- X ⑩ 390 OFF 470, 1418^{LF}
- X ⑪ 371, 1617^{RF}

Buttonwood food - #7.10 check

Presence - activities of military

Need Game Warden at FFS -

Thur
MAY
080
FRID
MAY
SUN

04
col
fo

Ask Buttonwood MAN
About FFS EAST MAN -

MAY
FRID
SATU

Thursday
MAY 15

at 1200h will be 130 miles from FFS -

0800h $\bar{x} = 12$ knts

FRIDAY 16th

MAY 16th
SUN UP

ARRIVE FFS - 1 turtle 1413 released
at boat - swan around aw-hilo then
dove - Remained of turtles released
on way to Whale-Skate ~ 1400.

Fecal material in crates contained -
weed-like material, line (string), plastic
Disembarked Tern Is. -

0900

collect
for eating
Philippinos

Terns along N side runway - breaking
200-300 eggs daily for last month -
5 pits along beach, one looks good -
Reported large increase in turtles 2 wks
ago. Basking on Trig-WhaleSkate, some small.

Man at Johnston Is CG 1972

Name - LAFAELE MATAUTIA - 800lb green,
taken 5 lb lead + hook, Throwing line.
Telephone 845-8836

Notes = oil leakage - Head pumped
overboard - Blasting 300' channel -
Stan Lianski - LORAN C install,
remove Loran A FFS 1979 shut down
date (new). (Tower on East Is(?))

Ask Buttonwood MAN
About FFS EAST MAN -

Consider in view
of Tim Harris
comments for
3/78

MAY 17

PREPARED BOAT - ALL GEAR

~~FRIDAY~~

Comments made on Riding Turtles -

SATURDAY

George ^{WV Teepe} indicated gathering of small turtles off Tern

Notes - about 1 month ago, Cook began using Tern eggs in station cooking - Crew complained and it was stopped.

Noddy Tern eggs get broken with Sootys -
Vegetation along / in runway the problem
Sooty Tern given / sent back with Buttonwood
same birds re-baying to the West on Tern?

Breaking any other eggs at other times?

No guideline of what level, if any, of nesting is acceptable.

only a few signs of pits/digging

continued

~~FRIDAY~~
 MAY 17
 Saturday

Reviewed Joel's Temperature-Turtle observations
 Russ tends to confirm that large
 increase in turtles on TRIG; ^{repet.} W-5 occurred
 about 2wks ago - however, George indicated
 that 13 seen on W-5 one week
 before Rollison departure. - Buttonwood-
 Mallo departed.

MAY 18
 SUNDAY

Launched boat, to East w/ Joel, set
 up camp, surveyed East (far left),
 LGIN, GIN, INNER KEET, W-5, TRIG,
 return to Terry. Photos of notched
 male, oil, basking turtles, tag #1410 TIME
 basking on Trig. Turtles appear to
 "look around" when first coming out to
 bask. Photo of algae taken off L. GIN and
 on shore at Trig, Tumor dorsal flippers W-5.

MISC observations by Island -

^{Green} East - short sand point, oil remaining,
 many albatross chicks, many small sharks
 LGIN - a little more vegetation, BF Albatross,
 BF Boobies, some new oil, Noddies

^{Green} GIN - copulation off back side in shallow water
 whale-skate - small amount oil remaining, some
 erosion into organic zone (on SW side)

Trig - Dry, no sooty tern population,
 sand point extends to sand island

Terr - Green, growth on runway, Terns nesting,
 big scavenger, Mesersmitti - RF Boobies abundant,

only 3-4 instances of copulation noted.

only a few signs of pits/digging

ble.

MONDAY out with Joel Whitfield - to shark, outside
 MAY 19 reef off Tern, Round, East (clean oil),
 Dive off mullet, Dive inter-lagoon,
 Whale-skate.

937, 938 male Basking on whale-skate. Two captive
 turtles seen by Tide shack - 1 w/ deformed PCs.
 Male turtle on W-S, photo, notches in marginals -
 same as last year? Underwater photos of greens -
 Many Seals w/ new pups on Round -

QUESTION: Increase in Basking adults appears
 to occur from January on, but
 only or predominantly on Trig and whale-skate
 Will some of these turtles use East for
 nesting? Do they change islands
 in mid-season perhaps due to less
 desirable soil characteristics on Trig
 and whale-skate (thereby accounting for
 "late arrivals" on East) Note TC 27
 seen basking on Trig but later nesting
 (and previous) on East IS.

No. times P. Sekora visited FFS

TUES
 MAY

capt

Wedn
 May 2

SEA W

TUESDAY
MAY 20

- ⑥ Certain areas should be "off limits" - restricted
- ⑤ ask about Tern killings
- ① Purpose to eliminate all sooty Tern nesting on Tern?
- ② Landing on other islands - regular trip -
- ③ Sending fish/coral to Honolulu -
- ④ Sooty Tern Eggs to Honolulu -

Oil 80% cleaned up this date on LGIN - put in plastic bags and buried!

Swam with copulating turtles - many photos - Tracks seen on S side of Trig - unusual - at Whale-Skate, water warm in close to shore (shallow: less circulation?) Deep holes, drop off adjacent to favored basking areas - protected against large sharks? Channel that goes behind W-S and Trig connects to? Check aerial photographs, charts, etc.

captives

When swimming in water, behind baskers, they could see me well and many departed (or see something "different")

Two captive-release turtle by tide shack Dark shell for absorbing sunlight?

Wednesday
May 21

SEA WATER 26°C

To East - Grayback Terns present - have a different sound? Difficult to paint faint TC no. while basking due to water. Mating mostly in protected/safe areas of East and Whale-Skate.

Photos at 1800h of basking turtles on Sand Point. "Repeated disturbances" of basking turtles at unique location. (boats/walking). Termites on East. Less sootys on East than last year.

Note: Hawaii Clipping Service -
Star-Bull. Dec 10, 1964 article concerning cat loose at Tern(?)

The Elepaio

Hawaii Audubon Society

P.O. Box 5032

Honolulu, HI 96814 reg. membership #3.00

Wed
MA

Thurs
MA

Thurs
June

June 6
Frid

Wednesday
MAY 21
m(?) If oil had been noted by CG after my Feb. visit, contact with animals would have been considerably less. Basking early in season for egg development. Copulating pair beached - Area 8
Basker covered with sand on SEP.
Brighter light now on Tern.
C.O. in shear-water holes on East -
CG 4172 FFS chart - need to purchase -
Kill a few Terns - airplane hits them anyway -

Thursday
MAY 22 Secure Tent-Camp, To Tern, haul whaler -
P. SEKORA visit - Depart HONO, VIEWED streaks, spots in ocean off Necker area - some large - pilots opinion 10-15' wide - some 10 miles long, viewed at 2 miles distance, 9000' altitude. Photo B/K w/

Thursday
June 5, 75 To FAA, no space available - made contacts with Lt. Brock -
John K. reported fishing boat Sea Hawk from Seattle(?) arrive FFS May 25 (eclipse of moon), fish outside reef (Lakerouse) for tuna traps for lobster (bait with dead birds) - still there as of Thursday May 29 - took Russ, Whitfield, out fishing. Told me "no more coral" ^{by order C.O. HERTZ} (Sekora to call on 6/6

June 6, 75
Friday Paid for 1/2 flight \$234.30 - Depart 08:35 FAA
"Sea Hawk" had engine trouble (Larry) - PERMIT.
Coast Guard Report 2 captive Release around Tide Gauge.

NOTES-

East Noddy Tern band 923-13188

Did Sea Hawk see turtles at Gardiner Pinnacles?

Did they land (FFS-Gardiner Pinnacles)?

Hind limbs seem very susceptible to shark attack - hang out.

Early turtle reports present problems in differentiating between basking and nesting.
 Sectioned needed on "History" or "Historical background"

Need Sea Water temperature data graphed by week or month -

esteem vs degradation

Take away something that was never had in the first place -
 Reports on aircraft buzzing Islands subchaser-P-?
 long tail?

Jedry's address - Thompson

Cernak's interest in Shark Island?

Kauai - Lots of ^{Turtle} shell collections at Kekaa -
 older Egg laying by Nohili Point -

Note Shark that chased small turtle into shallow water, possible to relate to initial stages in development of basking habit?
 Partially injured coming ashore - satisfying

FRIDAY
6/6

183

2300

6/7

18

6/8

SUNDAY

6/8/30

6/8-6

6/9-6

FRIDAY
6/6/75

← Landed whaler - to Trig (sand point still present),
little indication of nesting, many newer Scaevola,
To W-S - some of the Sooty Tern chicks are big (feathers)
To East via Round and Mullet, Sand point still
short, some evidence of nesting, None of the Sooty
Tern Eggs have hatched? ^{NOTE:} Late for season -
→ Have 189 951 US Wildlife - never locked - from Reddish ♀ ^{TRIG}
Saw 1 Subadult ♂ on way to Trig.

1830 ONEAST - Photos of female with notch in left
marginal out for nesting purposes A16-17.

2300-0130 Seal born A4 ~~11/11~~ - Photo 1830 6/7

6/7 Saturday Remains of older dead seal pup and aborted fetus A-5.

1830 Gold colored, small turtle basking NEP, PHOTOS BIK dorsal limbs.

6/8 high rain last night - much ^{bird} egg damage by turtles -
embryos well developed.

SUNDAY

6/8 1300-1500 LGin - Vegetation spreading ~ 213 BFA Chicks
GIN - Juvenile swimming close to shore - 2 large UUA,
a few patches of vegetation

6/8-6/9 Another new pup born in A5 - /swimming (wet) ^{6/10/75}

1300 To W-S on to Tern for dinner -

Many underwater photos of turtles and seals -
Few few pits apparent. Large, feathery sooty
tern chicks this location. Juvenile
captured with Codium in mouth, pink
encrustation on carapace.

6/9-6/10 Turtles do not fight easy, thus far. MOON?

Males seem to "patrol" shore lines.
Note: compile no. eggs per clutch by progression
into nesting season.

NOTES:

Public may take HINWR for granted - How can we use them - Carlquist
 Harassment - How do you exercise control over fishermen -
 - Seals go out to sea for food - extended periods -
 Importance of banks to turtles -
 Bird abatement at Midway - Towers - RUNWAY - RUNWAY paving EASTERN
 Habitation - RATS - KURE - RATS - Driving off seals at Midway - Glass Balls
 Use of NHI for military maneuvers (FW office) - Refuge budget -
 overflights by aircraft - Pillage by bird hunters - fishing station
 at P;H - Glass balls at FFS - Tern Is egg abatement - State Fishing
 permits - Blast part of Gardiner Pinnacles (Roll) - Turtle removal by
 Aagaard - ARB on NHI - Proposal to give NHI to U.N. -
 Wilderness Proposal - KRidler arrived? Before - State contract?
 CREATED 1909 - LORSTA 1945 ON EAST - Fishing History FFS - LAYSAN (LIS) GUANO
 BLASTED CHANNEL / PIPELINE KURE, date? - LESS SEALS AT KURE -
 FFS remove coral - Recreation area for men - OIL ON BEACHES -
 FREEDOM OF INFORMATION Act - CG MOVED TO TERN IS. WITHOUT
 PERMISSION - KAULA BOMBING - STOCKPILE goods by Military ON EAST -
 STORAGE OF FUEL (FW OFFICE). Lights from Tern Is. - hatchlings -

CONSIDER order areas are utilized as season progresses -
 1975 - thus far no emergencies in A12 there as many
 early in 1974 Season.

6/10 T

6/11 We

6/11 - 6/11

6/13 Fr

14.

6/13 - 6/13

1130

6/10 Tuesday Basking turtles/seal pups are not frightened by one another - seem relaxed - note implications of new turtle arrivals to atoll.

Note: Thus far, few TC numbers have been noted on basking turtles.

6/11 Wed.

What do turtles do / where do they go during interesting interval? Juveniles appear to commute daily (with tide) to N. Reef of East.

"Fat" on seal acts as protection from shark bites. 6/11 0145h pup born on East.

1600h W-S very few baskers - why? 2 pups - one nursing other.

6/11-6/12 Thurs

Seem to be 5 SWP newer A2-5, pair w/ pink bel. cal cord sprayed white on tails.

6/13 Friday

Population scars seem to heal fast - few goshes in ~~canopy~~ canopy
1430 → observation on Sand Point, when 1 comes out to bask, many follow - or else, all are coming out together (same time) Related to tide coming in?

OBSERVED JUVENILE OFF EAST SWIM WITH NUMEROUS SMALL SHARKS - NO ALARM (SPECIES RECOGNITION?).

WHAT IS STATUS OF ADULTS WITHOUT TAG -

- ① NEVER PREVIOUSLY TAGGED - MISSED
- ② LOST PREVIOUS TAG
- ③ NEOPHYTE NESTERS

Consider Turtles apparent "KNOWLEDGE" OF AREA, e.g. UNDER-WATER AROUND IS, CONGENIALITY WITH SEALS, fear of MAN(?)

(AS OPPOSED TO SEALS)

6/13-6/14

FIRST USE OF AREA 12 THIS DATE
Erosion occurring along A9-16 - steeper bank, large coral chunk exposed in intertidal zone.

1130-1230

Some Sand point basking at low tide - when one comes, others come.

TO PAGE 99

TAG NOS. -1006^{RF}

100.3 x 88.3

C 39 1/2 x 34 3/4

CSLW - 1.07

CSW - 1.21

SS - 1.29

TC - 22 -

47

94 x 73.0 28 MAR 2002

S 37 x 28 3/4

<u>Date/Time</u>	<u>STATUS</u>	<u>AREA</u>	<u>REMARKS</u>
6/8/95 0200	NF	4	FIRST SPRAYED
6/8 1430	B	GINIS.	
6/9 0015	N	7	<u>LAY</u>
6/22 0030	N		
6/23 0300 ⁰⁶⁴⁵	N	2 → 3	poss. LAY

//////

TAG NOS. 1005^{RE} 7074LFI90.2 x 88.9
C 35 1/2 x 35CSL - 1.05
CSW - 1.28
SS - 1.24TC - 23 - 5F
85.7 x 69.228 MAR 2002
S 33 3/4 x 27 1/4

DATE/TIME	STATUS	AREA	REMARKS
6/8 0200	NF	5	First spray, RECENT BITE OUT OF RIGHT HIND LIMB
6/8 2130	B-N?	8	Feeding on beach, TAG ^{NO} more
6/9 0015	B	8	
6/11 2300	B-N?	S.P.	
6/15 2300	N	6	
6/17 2230	N	2	^{cluster} numbered foded BARN 2 nd 2AT Right
6/18 0215	N	2-3	LAY, RHL 1/2 miss 83 EGGS (1 1/2 size)
//////			
7/26 2230	B	SEP	
7/28 0115	B	8	RHL 1/2 miss, Seum on shell
//////			
8/27 0439	N	7	
//////			

TAG NOS. - 997^{RF} 1091 RFLAP
 96.5 x 87.6
 C 38 x 34 1/2

CSL - 1.08
 CSW - 1.25
 CS - 1.28

TC - ~~24~~ 55
 89.5 x 69.9
 S 35 1/4 x 27 1/2
 APR 2002

DATE/TIME	STATUS	AREA	REMARKS
6/8 ⁷ 0230	NF	1 BY TENT	Mistaken for laying, Tag
6/8 ⁸ 2130	N	S.P.	
6/9 ⁸ 0030	N	17	
6/14 1800	B	SEP	
6/19 1800	B	SEP	
6/19 2300	N	1	
6/20 2300	N	16	
6/21 ^v 0100	N	15	LAY 126 EGGS 1091 through existing hole (from tag), pieces missing LFLAP, Broken Coke Bottles marked location
6/24 1700	B	SEP	
//////			
7/27 ²⁵ 0100	N	14	
7/27 ⁹ 2300	N	1	mistakenly sprayed TC1
7/28 0400	N	7	LAY
//////			

TAG NOS. 1084^{RF} 1108^{LF}

96.5 x 96.4

CSL-1.06

91.4 x 70.5 TC-25 59

C 38 x 36

CSW-1.30

02 APR 2002

CS-1.30

S 36 x 27³/₄

<u>DATE/TIME</u>	<u>STATUS</u>	<u>AREA</u>	<u>REMARKS</u>
6/8 0430	NF		First spray, Left Hind 1/2 miss
6/11 1430	B	SEP	
6/13 1600	B	SEP	
6/14 1800	B	SEP	
6/17 1600	B	SEP	
6/19 2300	N	7	
6/20 ¹⁹ 0230	N	5	Tag placed through existing hole
6/21 2230	N	5	
6/23 ²² 0100	N	5	LAY, R Flop has partially closed hole
			

TAG NOS. - 1013^{RF} -

92.7 x 87.6
C 36 1/2 x 34 1/2

1021 RFIAP

CSL - 1.05
CSW - 1.34
CS - 1.35

TC-26

63

88.3 x 65.4

S 34 3/4 x 25 3/4

02 APR 2002

DATE/TIME	STATUS	AREA	REMARKS
6/8 ⁷ 0430	NF	4-5	First sprayed
6/8 2130	N	6	
6/9 ⁸ 0200-0500	N	6	
6/10 ⁹ 0030	N	5	ross LAY, TMR LEYE, LFVENTRAL limb, GroundWIRE
6/10 1430	OFFshore	Nshore	
6/22 2300	N	5	
6/23 0430	N	4	LAY, RHL sm/TMR dorsal

SM TMR RFL ventral



TAG NOS. - 999^{RF}, 1110^{LF}
 96.5 x 88.9
 C 38 x 35

CSL - 1.07
 CSW - 1.23
 SS - 1.25

TC-27-

67

90.2 x 72.4 0₂ APR 2002
 S 35 1/2 x 28 1/2

DATE/TIME	STATUS	AREA	REMARKS
6/8 0600	NF	4-5-6	First spray - Poss. 1Ay
6/13 1600	B	SEP	
6/23 0200 ⁰⁶⁴⁵	N	6	LAY Some Gold
//////			
7/19 2300	N	4	
7/20 0300-0600	N	5	passing?
7/20 0100	N	11	poss 1Ay
//////			

TAG NOS. 1004^{RE}

102.9 x 100.3

C 40 1/2 x 39 1/2

CSL - 1.06

CSW - 1.31

CS - 1.27

TC-28

97.2 x 76.8

S 38 1/4 x 30 1/4

71

02 APR 2002

<u>Date/Time</u>	<u>STATUS</u>	<u>AREA</u>	<u>REMARKS</u>
6/8-72130	NF-	6	First spray - Tag
6/13-1430	B	S.P.	
6/14-1230	B	S.P.	
6/14-1800	B	SEP	
6/22-0600	N	12	Poss 1A, left Flap 1/2 miss
6/22-1600	B	5	
6/24-1400	OFF	13	
6/24-1700	B	SEP	
6/28-1300	B	S.P.	Chased by mother seal
//////			

TAG NOS. 1025^{RF}/

99.7 x 92.1

C39 1/4 x 36 1/4

CSL-1107

CSW-124

CS-125

TC-29-75

93.0 x 74.3

S 36 5/8 x 29 1/4

02 APR 2002

DATE/TIME	STATUS	AREA	REMARKS
6/9 ⁸ 0100	NF	S.P.	RH ^{3/4} miss, sec miss over LHL
6/10 1730	N-B?	2	top of tide
6/10 2230	N	17	nesting problem?
6/11 ¹⁰ 0800	N	S.P.	returning, Tag
6/11 2300	N	S.P.	
6/12 2230	N	5	
6/13 ¹² 0030	N	13	
6/13 1600	OFFshore	N side-11	
6/13 2200	N	1	
6/15 ¹⁴ 1800	13-N	S.P.	Sun bright
6/15 2230	N	1	numerous pits; shifts body, not digging efficiently
6/22 1600	B	S.P.	
6/24 1330-1700	B	S.P.	
6/25 1100	B	S.P.	

//////

TAG NOS. 1008^{RF}

94.6 x 94

C 37 1/4 x 37

CSL - 1.05

CSW - 1.36

SS - 1.30

TC-30-79

90.2 x 69.2^{0.2}

S 35 1/2 x 27 1/4

APR 2002

DATE/TIME

STATUS

AREA

REMARKS

6/9³ 0100

NF -

2 -

() LAY

Deform R Front
Carapace

6/21 2230

N /

3 /

LAY /



TAG NOS. 1009^{LF} -

97.8 x 90.2

C 38 1/2 x 35 1/2

CSL - 1.06

CSW - 1.27

CS - 1.30

TC-31-83

92.7 x 71.1

S 36 1/2 x 28

APR 2002

DATE/TIME	STATUS	AREA
-----------	--------	------

6/9 ⁸ 0100	NF-	2-
-----------------------	-----	----

6/14 0015	N/B?	8
-----------	------	---

6/23 0200	N	5
-----------	---	---

//////
 ////
 ////

7/20 0130-0600	N	6
----------------	---	---

REMARKS

RFL

LAY

believed to be c11009

LAY

1009 Rotated

TAG NOS. - 1010^{RF}

93.5 x 88.9

C 36³/₄ x 35

CSL - 1.03

CSW - 1.23

CS - 1.25

TC - ~~32~~ 87

90.2 x 72.4^{0.2}

S 35¹/₂ x 28¹/₂ APR 2002

REMARKS

DATE/TIME	STATUS	AREA
6/9 0135	NF	5
6/17 1700	B	MULLET IS
6/23 0100	N	17
6/24 0400	N	12
6/25 0315-0700	N	6

~~LAY~~, Algal scum on shell
~~number faded~~

~~|||||~~

TAG NOS. 1012^{RF} -

95.3 x 88.9

C 37 1/2 x 35

CSL - 1.06

CSW - 1.32

CS - 1.33

TC-33

91

89.5 x 67.3^{0.2}

S 35 1/4 x 26 1/2

APR 2002

DATE/TIME

STATUS

AREA

REMARKS

6/9⁰ 0200

NF -

17

Lay, MARKed Loc ^{some} Goldish ^{Photo}

6/9

1830

OFFSHORE

N shore

6/24

0215-0330

N

1 -

by tent

Gold

//////

all do this

TAG NOS. - 1020^{RF} -

99.5 x 1019 LAAP

C 39 x 37 1/2

CSL - 1.06

CSW - 1.32

CS - 1.29

TC-34-95

93.3 x 72.4 02 APR 2002

S 36 3/4 x 28 1/2

DATE/TIME	STATUS	AREA	REMARKS
-----------	--------	------	---------

6/9/20600 NF- 7-

6/9/2230 N 11

6/10/0030 N 10

6/23/0200 N 8 LAY, Marked location
W-out, 0300 Area 7

6/23/2230 N 3

6/24/2300 N 4

6/25/0245 N S.P. → 1

//////

7/24/2230 N 17

7/25/0100 N 1

//////

LAY, series of photos, Ektachrome

6/16/81 - East - N TC 38 EXT. No. 144

check differences in Monel composition over the years -

* Need photos of TAGS AND PLIERS -
Address to RUSSELL

SUN

6/14-6/15

appears to be fewer basking males now present - those sprayed may not stay around East (?) Some nesters appear to have larger surface in hind limbs. In digging egg chamber, when placing hind limb into hole, limb "pivots" in order to miss edge and lessen cave-in. Sooty TERNS approach East from West (flying into the wind), flocks seem to arrive around sunset - depart at sunrise.

More coral growth along East's south reef flat? Seals sleep belly-up to take advantage of light colored side? Is it possible that East turtles are not an initial part of Trig-WS group but rather arrive later in season (don't seem very likely?). all of sudden TC20 and male hauling out together SEP - related to height of sun?

4/15
SUN
1200

1400
NAIVE
ABOUT
BOAT

W-S numerous juvenile and subadult turtles in West Bay. Caught 4 from boat - appears to have been a recent influx of animals - note that 4 caught are same size. SLEEPING BF BOOBIE - TAG NO. 757-26083 ^{Correct}

6/16 MON.

Do seals go up to higher ground when bad weather approaches? Are they up higher during Sept-Oct because of fewer birds? NOTE: Consider the progression of embryonic development after calcification IN THE TURTLE (after fertilization, before calcification(?) analogous to chickens?) when nesting is unsuccessful for a number of days. What is the effect on early embryo mortality - possibly a short paper in itself. Consider the effect of diet/algae on pigmentation in larvae - see algalogist.

MONDAY 6/16 Dinner at TERN - caught large sub adult with net from boat at Whale-Skate -

disgrace ROUND - Questions: Source of Barge at Whale-Skate?
JUNK ON SHARK - Red Bricks seen on W-S & EAST?

NOTE: Humus exposed, eroding along portion of SW (By beach rock) section of ~~WHALE-SKATE~~ -

BASKING TURTLE CAN "SEE" considerable DISTANCE Across Whale-Skate -

Plan needed of ground wire on East - size of grid, extent - Turtles detrimental to this system - did they "abate" nesting during early years? Birds?

What signals "take-offs" in sooty Tern colony?

1800h Three captive-release greens now staying around tide gauge
Reported CG has caught two (fish line tangled in flippers)
Adult MALES who have successfully copulated should ^{most} ~~likely~~ possess bits and lesions on tail, limbs, etc.

6/17 TUES. Compass Direction of FAVORED BASKING SITES:
EAST-SE; W-S-NE; TRIG-N (all subjective).

After egg chamber has been completed, plaster end hangs out slightly over hole. Does this serve a purpose - possibly aiding in extrusion of eggs?
Note - LARGE "PAD-LIKE" scales on dorsal surfaces of hind limbs - possibly acting as cushion during egg chamber excavation.

Turtle Turned while BASKING (for tagging) may be less apt to bask during SUBSEQUENT SEASONS?

WHERE WAS CG DUMP ON EAST? OLSEN Blkwt before cleanup.

Early morning hours 2 SWP seen swimming A14-15 (A2-3)
Some Sooty Tern chicks now present - young do not move out of turtles path. Juveniles full feathered on W-S.

Photograph

6/17 Tues. Some juvenile/subadult/adult turtles have white scum on shell - other do not. Related to basking? Black-footed albatross chick census - 861 - most moved out of A5-6-7, concentrating along N side. Copulation seen outside reef area 5.

Where turtles may be between nestings - (1) Around East Is, basking for offshore (under coral ledges - note scratches in TC nos.) (2) Basking on a neighbor Island (Gin-LGin, Round-Mullet, Trig, W-S)

6/18 WED When covering, many turtles seem to make a curve to the right. If most turtles are on a 4 year cycle, 1972 tagging would not show until next year.

Need photos of sunset from SNEP. color

Newer pup Sand Point end of East within last few nights. Rusted can found on W-S with fluid inside!

6/19 Thursday Note Shape of carapace of captive reared, Midway and FFS Juveniles - compare.

1800h 3 new(?) pregnant seals noted - one apparently starting to give birth.

NOTE: Number turtle per night (successful) X DAYS/cycle = TOTAL Number Animals for season (?). Estimated No.

Turtles X NO. Nestings averaged/individual X mean clutch size X nest survival coefficient X intertidal survival coefficient =

Hatchling Productivity. NO. NEW SEALS X TIME

6/20 FRIDAY CARAPACE SIZE by CLUTCH SIZE. Most of egg deposition is occurring after 0100 after several unsuccessful pits - seem to "get down to business". When males first come out to bask, their tail is straight out - later becomes curled. observed male apparently "chasing" female out on sand point. Male returned after a few minutes - female remained long time.

1230

extensively utilized by sea birds and Hawaiian monk seal.

ALBATROSS CHICK FEEDING TAKES PLACE DURING NIGHTTIME. HOUR
6/20 FRIDAY Greater Incidence of Basking among males with old
injuries/abnormalities? Fright Response of nesting turtle
seems to be increasing with increase of moon stage. ON
SOME TURTLES, STRUCTURE OF RIBS is apparent.

6/20 Seal census on EAST includes Adult with \cap scar central, no
pup around but in photo 2 days ago; Adult w/pup (new
since arrival) has puncture like scar on back; and also
new at arrival pup (w/adult) that lacks pigment in tail area.

1700

Hard 15 minute rain did not cause SEP baskers to retreat.
No Baskers on NEP, possibly due to onshore wind/rain? Do

?

Shearwaters move their eggs in and out of burrow?

6/21 Saturday

Diminution of digging when head goes low into hole could be
beneficial in that entering into already laid clutches
could be lessened. Extending hind limbs over egg chamber
may aid in egg laying (i.e. easier to expel eggs).

Note: All Turtles do NOT BASK AT THE

SAME time. What is the controlling factor? (space)

Appears to be variation in length of time till pup
weaning. 1800h Full Rainbow across EAST IS.

MAIN Island SUNRISE - 5:50 AM SUNSET - 7:16 PM

6/22 SUNDAY

Lightning to S and W during night.

Application of tag to flap areas appears to be more
painful than distal flipper.

New animals that ^{are} still showing up could be transfers
from Whale-Skate/Trig?

Could seal sand rooting serve to protect from wind, such
as crawling into turtle pits?

Tail straight down while laying eggs. Turtles start out
at Trig-Whale-Skate, end up at East?

variation in
pup weaning
SIZE

6/23 Monday Hard rain SE starting ~0900 - lightning.
Rain erases traces of tracks and recent nesting pits.
Many of Kridler tags may have fallen off.

- "Page _ of journal copy contains printer's error which has been corrected in this reprint"

6/24 Tuesday Was SW surf responsible for poor success ~~and~~ last night?
Turtles while basking or nesting are not frightened by seals or birds, therefore must be accustomed to them (from other locations?). With TC numbers without tags, some turtles may be recorded twice. Pounding stake into ground did not obtain response from basking turtle. Fertility of clutches decreases as season progresses? The repeated nightly nesting emergence by ^{some} turtles may only be a response to the animal not being physiologically "ready" to lay. This could be manifesting itself in what seems to be an inability to excavate a suitable chamber.

Repeat

6/25 Wed Two cement slabs exist in A14 that are half washed away and are at the vegetation edge - Examine old Aerial photographs and compare with recent to determine erosion.

Differing threshold of pain exists among turtles.

Approach to A5-6 would not seem desirable.

TC-28 seen being chased - bitten(?) threatened by Seal w pup on Sand Point - Turtle returned to water - but not in alarm.

1230 - Flattered tent, gear, covered with tarp.

1830 ~~at~~ TRIG Island - copulation observed - N shore - one pair only. Considerable plastic area is exposed by male when pair "lists". Lots of "paired" seals on Trig - evidence of male's fighting - pairing due to lack of pupping at this

all of this

Small need waterproof on top - Gear case lubricant -
Need 2 short pieces steel rod -

6/25

location. Boobies (BF) observed "talkin" in groups (paired).
Crickets heard on Trig. Long sand spit still
entire. Humus layer noted deeper under coral
substrate. Concave indentation noted along spiral
area of basking adult female.



If FFS turtles are to any degree site
specific by island, subpopulations would tend to
become genetically isolated (assuming specificity also
encompasses males) "reproductive specificity".

5° Radials

Concerning ground wire for antennae, copper wire
radiates out at 5° intervals (72) and is usually
tied together where it meets another one. ET
Chief showed some concern for turtles resting on Tern
and possibly tearing up system. It is desirable
to have tie down rods at intertidal zone.

Guest Book
Notes

NOTES ON USCG TERN Is SCRAP BOOK - GUEST BOOK

1957 - Jerome R. Cronk, C.O.

Aug, 1957 yacht "Seadrift" at Tern Island -

May 27, 1967 2 "sea snake" photos (bob) -

FAA was flying during April, 1969 -

May 24, 1969 Turtle Riding (shows male) -

May 24, 1969 C.O. Kofron says - "getting that seal"

1970 (or later) - C.O. - H.F. HIRSH

DATE UNKNOWN - Shows seal in a cage

Nov, 1972 Photos and messages relating to Soviet Naval
Vessel anchored by La Perouse (No. M6-12).

Aug 5, 1971 & MAY 18, 72 - Women at FFS for blood donations

BOOK ON 1969 High WAVE DAMAGE -

CONTINUED PAGE 108

TAG NOS- 1117^{RF}

TC-AVI

105

102.9 x 100.3

98.4

02

APR 2002

C 40¹/₂ x 39¹/₂

S 38³/₄ x

DATE/TIME

STATUS

AREA

REMARKS

6/26 0200

NF

TRIG

LAY

LHL =

U

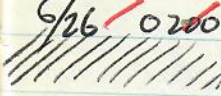

001-05
#105

02 APR 2002

TAG NOS - 1118^{LF}, 1119^{RF}

TC - AV2

94.6 x 88.9

C 37 1/4 x 35

91.4

S 36 x

DATE/TIMESTATUSAREAREMARKS~~6/26 0200-0700~~~~NF~~~~TR16~~~~LAY 111 EGGS MARKED LOC~~~~Goldish w/ speckles - some brown head, dorsal fins~~~~7/31 0015~~~~N~~~~Whale-Skate Central, E~~~~7/31 0600~~~~N~~~~Central, E~~~~8/2 0100~~~~N~~~~w-s NW point → Central, W~~~~Poss LAY~~~~8/4 1230~~~~N~~~~w-s Central, W~~~~Poss LAY~~~~8/4 1900-2330~~~~N~~~~w-s South, E~~~~LAY~~~~never located the favored
South, W. nest grounds.~~

TAG Nos - 1122^{LF}, 1123^{RF}

TC - AV3 - 107

CSL - 1.04

02 APR 2002

88.5 x 67.9

CSUS - 1.23

91.4 x 83.8

SS - 1.30

§ 34³/₄ x 26³/₄

§ 36 x 33

DATE/Time

STATUS

AREA

Remarks

6/26 0200-0700

NF

TRIG

Tagged - but continued digging activity
1122 rotated

7/29 2330

N

Whale-Skate, South, W

BARN 2nd LAT R

7/30 0230

N

" "

LAY

all of this

CONTRACTOR FOREMAN - RAY WAI - WORKING DURING NOV 72
JOHN KAHIAPO (?) EATING TURTLE ON MAUI - INTESTINES - Belly plate

Julian
Coast
Co.

8 X 10 Blk and wt photo showing steel plates
exposed along S side of Tern Island by wood
mast radio beacon and metal LORAN tower.

FRI
7/18/75
800
6

NOTE - Why DOES BARE AREA EXIST ON EAST IS A 5° 12'
6/26 Thurs Vic - Tel 689-0541 KH6-HJM reported flying FFS ~ 1948

1345 DEPART FOR HONO FAA D-3, Lt Kimsay aboard

6/27 called Vic - flew Navy R4-D 1948 (?) said it was (NOT FFS) (GSTA)

7/19 SAT

* Check for possibility of Radar Reflector on one of
FFS islands. Overheard by Hertz - unclear if landed.
Concerning Kaidler's ^{tagged} returns, on what island were they
originally tagged/engaging in what activity.

665
942
FRIDAY
7/18/75

DEPART FAA, Flight paid by SKORA-5090 - AIR
0830 conditioners aboard, + Lt (sg?) Kishman - pilots Hyatt's ^{GS-15} smoker
CO. of OMEGA station KANEHOE - Fin world, span antennae,
broad coverage.

CONCERNING ENGINES ON DC-3, air intake located on
top of motor, baffled for by-pass of foreign objects. Oil
cooler on bottom - apparently not serious if bird
gets through prop into Vite. Bird on cylinders
may cause "hot-spots"

7/21 MON

Photo of Lehua - Lava flow noted at shore
areas of Nuhau.

Hyatt indicated saw Seattawk fishing (outrigger
set) inside Shoals.

1715

(Survey of - Leeward Hawaiian Island Insular
Resources ^{early} against Clomwell article in 7/17 Advertiser

7/22 TUES

Aerial Survey - Blk wt Photos -
Hyatt Seal Count - DISAPPEARING = 45 (Noodie Terns?)
LGIN/GIN = 20 EAST = 55 W-S = 65 TRG = 20 SH = 11

1200

CG YAP ^{LOBAN} NATIVES to get turtle shells.
BIK'ut LA Perouse

109

FRI
7/18/75
1000
♂

Very Few basking Turtles noted, copulation + 1 male
Landed and launched Whaler - TOTRIG
Trig is close to N reef (Amerson Paper). Turtles
nest on high sections. Shearwater have
difficult time digging satisfactory burrow?

7/19 SAT

TO TERN - TO whale-skate - only a few LAYSAN
and BIKFT remaining, same for East. Most BFB^{IVE} boobies
are well feathered. White painted TC BASKING W-S NOTAG
TO EAST - set up camp. Sand point short. a few
Laysan left. Wave action cut into area 10-11, ground
wire exposed, undermining round fog. Note that
many seals are (seem) seen with torn tail where
tag should be. FEW SOOTY TERNS ARE PRESENT.

NOTE: Is it possible that Juvenile ^{TURTLE} color is adaptation
for blending in with back-ground e.g. light colored coral?
SEASONAL NATURE OF GRAY REEF POPULATIONS.
HOW ACCURATE IS CENSUS OF GHOST CRAB HOLES?

7/21 MON

Shearwaters are out/very abundant early morning.
ON 7/20 OBSERVED DOG CHASING EMERGING SEAL INTO WATER.
Few ^{turtle} tag recoveries during subsequent seasons - normal attrition
in breeding population - from man (?) shark (?) natural ^{OR TAG LOSS?} physiological
causes (?). 4 Coast Guard personnel to GIN - LGIN ON ISLANDS.

1715

Turtle up on SAND POINT FOR NESTING. Caught 68" GRAY ♀ - stomach -
only small piece of TRIGGER FISH. CG Report 60" ♀ - 2 pups stomach ♂.

7/22 TUES

Possible tracks from hatchlings sand point 7/20.
Many smaller sub-adult seals NEP. LARGE SHARK
OBSERVED CIRCLING BUOY-SA IN AREA - SCARED SHARK?
SOME EGGS APPEAR TO BE SMALL. SPINNING PORPOISE (?) SEEN
~ 1 MILE OFF EAST (NORTH) ~ 100+ ANIMALS MOVING WEST.

7/23 WED. NO TURTLE PRESENT FROM 0300 ON. 0200 → 0400 SHORT
HARD RAINS - SCARED TURTLES?

7/24 Am Capt. Stonerborn Short rains - at ~ 1500 7/23/75 little 4-engine Air Force
plane flew over - estimated altitude 600-800 feet. No NOS.

7/24 PM Plane FAA late, Alex's last flight retired, ofihi shipped out,
New ET Chief Richard in, John Maple depart -
Formerly here 1964 - Smithsonian took / tagged turtles (?)

7/25 PUP measured - 61" photo
Apparently considerable variations exists in the weaning size of pup
4 rectangular cement foundations at island center must have been for generators
What was track for? Small boat launching? When were
steel posts put on offshore coral head? For seaplane runway?
Found ~ 10 eggs on sand point along turtle track. all with
peck-hole except two. Can grow in length take place
after weaning but before feeding on own?

ADULT TURTLES yellow / CREAM / GOLD ON VENTRAL NECK / THROAT
76 large Ghost Crab holes counted S.P. N shore end; ~ 26 S.P. south shore
9 N.E.P. - only few apparent at other locations - SAND PARTICLE SIZE CHANGES

7/26 SAT NOTES: RECORD GROUND TEMPERATURES AT BASKING SITES, WITH
and without dark BACKGROUND.

DOES COVERING ^{EGG} POSITION OF HIND LIMBS HELP TO PREVENT
EXCESSIVE COOLING FROM WIND?

INTERESTING THAT FEMALE WITH TAIL BITE NEVER OBSERVED.

SOME OF TRIG-WHALE-SKATE TURTLES FROM EARLY IN

SEASON COULD BE NEOPHYTES (MATING BUT NON-NESTING MIGRATION)

NIGHTLY NESTING SUCCESS RATE RATIO. FEWER TOTAL NOS. PER NIGHT

LATER IN SEASON COULD BE DUE TO A HIGHER SUCCESS RATE.

Weather condition affect work in atoll.

HATCH - fresh hatching with head off found area 4
WEANED PUP = 57"

7/26 SAT LIST OF JUNK ON EAST

ON Beach, Area 9 -

1. Large unit with copper tubes (desalinator; cooler?)
2. 4-cylinder engine block
3. Large bronze cylinder (further out into water)
4. Iron frame Δ
5. Large iron generator(?)
6. Approx. 10 misc. part buried items, size uncertain (includes tubewest)

A15-16: BEACH Catapillar tracked vehicle mostly Buried in Beach sand

- A9 IN VEG. NE: 1. 2- 4-cylinder engine blocks
2. 2- large iron generators(?)
 3. axle gear assembly
 4. large iron plate
 5. 2- small stainless steel box assemblies
 6. 2- similar large bronze cylinders
 7. Large bronze cylinder partially buried
 8. Large bronze double cylinder assembly, part buried
 9. Large bronze cylinder assembly w/ upright extension
 10. Large iron winch with handle
 11. Large iron and bronze unknown assembly (pump?) ^{part} buried
 12. Misc bronze and iron pieces, some part buried, ^{some} size unknown
 13. Misc ^{part} buried glass, junk, etc.

A7 in bud: 1. Rusted 55 gal drum

A12-13: 1. 4- concrete foundations - corrugated iron

A14: 1. 4- concrete foundations

2. 1- med. size concrete foundation, vegetation edge

A15: 1. 1- large concrete foundation

2. 4- cylinder like iron tanks

3. misc. numerous part buried metal, concrete, ceramic, wood etc. Cable and wire everywhere

9' Radar tower (3 or 4 leg) on East
WIRES strung between antennae masts to make-up for height.

7/26 SAT. ♀ Blackish booby S.E.P. - thermometer bulb on dorsal carapace - 31°C; in air along side - 30°C.

HATCH

Live hatchling found coming out of Area 9.
Keeping track of nesters is a matter of bookkeeping.
Possibility of class action suit against CG to have them remove

Cenchrus cernatus
Burrgrass

their property from Federal Refuge property. Danger of transferring bur-weed from Trig-Tern to other islands

7/27

NEW PREGNANT SEAL APPEARED ON EAST SEP - where do they come from?
SEAL "ROOTING" TO MAKE COMFORTABLE PLACE TO LAY
1 pecked egg, watersedge sand point end. Ghost crabs North s.p. = 25
South s.p. = 51

Ghost crabs

19 SEP; SEAL PUP BORN 0300-0400 7/28 SEP.

NEST OBSERVATIONS ON TC III A4:

7/28 MON

after digging out body pit and anchoring in with front limbs, and with body (carapace) stationary, hind limbs

limits of depress in Body pit

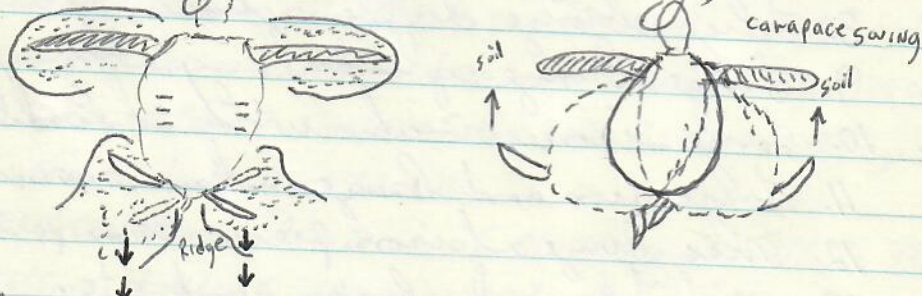

rotate in unison like an incomplete propeller throwing soil

Next phase shows body (with front limbs still firmly anchored) starting to swing with each move to the right and to the left having some soil thrown forward with the dorsal side of that same hind limb. This

7/28 MON

1830

0500-0530

HATCH

7/28 MON

gradually progresses into a "digging in" with the alternate hind limb ^{swing} that is over the center of the body swinging action. Thusly - into (following left hind) (body swung to left) throw soil forward, swing to center, scoop, deposit on left, swing to right, throw forward with RHL, swing to center, scoop with RHL, deposit soil on Right, throw soil forward with left. This rather quickly progress into a non-swinging situation. Perhaps initial swinging aid in breaking down ridge that has built up between hind limbs.

EXCAVATION OF TC3 5/22 2 Hatched but dead - nothing else.

EXCAVATION OF A5 unmarked - 21 Live - 2 BKWT Photos, NOTE white on dorsal Hind limbs close to carapace.

Banded (Red) FRIGATE BIRD NOTED ON EAST.

1830

MOVED TO WHALE-SKATE. NOTED Flock of perhaps 100-150 ^{FRIGATE} BIRDS. DEPIGMENTED FUR SPOTS NOTED ON QUITE A FEW SEALS.

2300-0530

HATCH

Ghost Crabs - S → to TENT (whaler) = 250 holes; Tent → to N = 470
Along back side - out running around - Many large larvae, poss 5:1 to ceraptothalms. My tent closehole observations made - saw animals bring out sand, dumping, and "packing" entrance way with close surface. Crickets heard. Ghost crabs into center of island at narrow site. observed larvae trying to grab hatchling, but apparently too small. Large danger would appear to be hatchlings falling directly into burrows. observed woodies feeding on "batfish" right in W cove, W-S; also just outside reef S side East Island. The two nesting locations used this date (Central-narrow portion) (South, before non-veg strip) are composed of fine sand with medium coral chunks - no humus.

If they weren't there at the right time of year, - may not have seen any turtles (100' pole?) = more like 50-60
Possible paper covering reduction of nesting habitat Available.

7/28

- NOTES ON FFS ATOLL RESEARCH BULLETIN - ALSO USCG PHOTOS, WASH.
 Navy Photos from 1930's and 1940's obtained through Nat. Archives
 Current outside FFS - West to W-N-W
 Hawaii State Archives - FFS File 1871
 Bishop Museum Photos - Tararua Expedition
 Cook - 1778; La Perouse 1786; U.S. Exploring expedition sighted FFS 1841; formal possession for U.S. by Brooke 1859 in accord with Guano Act of 1856; Gambia (2nd trip) late April - early May "lots of turtle" reference N.C. (Brooks Island and Reefs west-north-west of the Sandwich Islands, Pac. Nat. Mag. 29: 499-504.; 1867 U.S. published maps 2, 3, 4 of NHI which aroused fishing interests; Ada 1882 took out turtle shells and oil et al. (see Hornell, 1930);
 First Biological Survey 1891 May 20 - June 5, see (Walker, 1909) - Log of Kaalokai, Hawaiian Gazette Co. Honolulu 64 pp; Late Spring 1894 yacht Ebon see (Farrell, 1928) John Camron's Odyssey, MacMillan Co. N.Y. 461 pp.
 1896 Sealing Schooner Mattie E. Dyer wrecked; June 22-25
 1923 Wetmore Expedition; Wetmore, A. 1925 Bird Life among lava rock and coral sand. Nat. Geogr. Mag. 48:77-100-1800
 also Munro 1941 Elepaio 2: 56-58; June 1932 Quail sea plane photo mission; 1932, 1933, 1935, 1936 (Tent City) 1937, 1938, 1940 - plane-ship exercises, training area - EAST AS A BASE CAMP; US NAVAL FLEET EXERCISES
 Tern Is. Naval Air Facility - extensive dredging Nov 1942 to June 1946
 Hawaiian Aeronautic Commission recommended use for commercial fishing, June 9 on through 1950's at times; EAST LORAN July 1944 - Oct 1952 etc.
 First C.D. John J. Roshti + 26 men, 7 ^{ROADS} antennae, 7 ^{Ground wire} groundset huts, 6 other buildings;
 Tern Is. 1960 to 1963 PMR; "POBSP personnel burned the remains of the buildings in 1965." OISEN/CG PERSONNEL CLEAN-UP 1973 MAY
 * WRITE FOR PHOTOS. TERN-CONSTRUCTED A NEW ISLAND IN ITS PLACE, COVERED

U.S. National Archives R.G. 80, CF - 797883-1
Navy photo of Tern 1932

consider forensics evidence of turtle killing

SAW EVIDENCE OF TURTLE SLAUGHTER

129 TERN

30 WEL

N Tern possibly LCVP landing craft 50-60'
W-S " LCM 36' landing craft

ESTIMATE suitable AVAILABLE
NESTING AREA each Island 115

7/29 TUES ^{new} TAR Globules along back side ^{EKTA photo viewer} W-S. Does Bird dropping fertilize local benthic algae? Seal notes: when does new silver color turn to brown (pups and adults)? adult males appear coarser, darker (some yellow on belly). 1973 probably had an unwarranted larger No. ADULTS vs SUBA. Consider seals on barge. Possibly LYP are never present on land. 1830-1900 seals along shore at W-S = gone.

7/30 WED 0700 - one seal emerging; 1030 many along shore.
NOTES: RETURNS ARE starting to suggest that reproductive events are long - possibly leave feeding pasture January 1, arrive FFS FEB 1, leave FFS Aug 15, ARRIVE PASTURES SEPT 15, TOTAL ETIME = 8 1/2 months, at FFS 6 1/2
CONSIDER THAT SOME BASKERS EACH YEAR ARE PROBABLY NEOPHYTES THAT HAVE MADE JOURNEY FOR COPULATION ONLY. (?)

1300-1800 Visited EAST, DUG AROUND MASTS - Main Antennae Foundation
Radiating ground wire - NEED PAINT, ^{wire cutters - snips} LONG MEASURING TAPE, BRUSH, NAILS, COMPASS(?) NOTE: IF tagging was causing Island change, many East nesters should be found on Whale-skate.

OLD ONE WITH DREDGED CORAL.

Pearl and Hermes Reef - SB 5/27/29 p1

Descrip - SB 12/29/66, A9: 1

Lisianski - P&H fishing station Pouchin (1926-1931)

Laysan - Guano works, food for feather Pouchers ~1902
(Possibly islands)

Midway - Naval Station

Kure - CG Base 7/1960

P&H - Naval war games (1935, 1937; 4" shelling 1942)
also bombed and stuffed)

go aboard landing craft again.
show pilot ARB photos
Rvss about Radar Reflector.
ORDER Through canteen.

7/31 Thurs

LANDING CRAFT AT W-S - is there a dredged channel leading in?
Was it turned over to black channel? Need details about mining.

* KENYON AND RICE AERIAL PHOTOS 1957.

SEAL REGURGITATION - ^{W-S} Slipper lobster, TRIGGER FISH, LARGE Scales (Parrot-fish?)
Greater percentage of W-S ^{Turtle} population Basks as compared to EAST?

Do weaned pups move between Islands? How soon? SEAL NOTES: During evening those remaining are up high in vegetation (Don't need water to cool?)

SEVERAL SEEN SHIVERING. Among pairs, male often nuzzles female when I approach.

GHOST CRAB NOTES: Particularly along Back (E) side crabs are very reluctant to enter water (Predators are?). When chased will eventually apparently enter any hole. Anyone runs down the beach and tag a turtle, but it takes patience, time and effort to tag on without disturbing it. Possibility of W Bay of W-S has been dredged - check other photos for possibility. HAS Bird feces limit

8/2 SAT

growth in large scrubbs on TRIG AND W-S? GHOST CRABS SEEM TO FEED UP HIGH ON BOTH FISH AND HATCHLING - 3 partially eaten hatchling found 8/2 AM. At 1230 proceeded to East with Joel

Whitfield - Located stumps of masts, erected and painted black marker posts. Photos taken of ground wire rings and excavated remains of main iron antenna. Oil globules noted along NE beach, on seals (also previously noted on W-S 7/31) Seal with fresh shark bite photographed. While on EAST CG whaler arrived with Hertz, ETC and BMC. Walker around island. Sunset at W-S, picked up 2 jars of globules on W-S, noted goose neck barnacles. Due to current patterns or whatever (wave, tide, wind?) NE shore of East, NW shore of W-S and SW shore of Trig is being seriously affected - cut into humus, vegetation zone.

8/3 SUNDAY

Proceeded to East with John and Whitfield to pick

SON

could Mast 2 have been moved since 1949?

8/3 SUN

of oil and take measurements. Progressing from West end of island masts are numbered 1, (2) (standing), 3, 4, 5, 6 (main iron tower foundation).

Soil over hard packed coral Roadway A7 by 55gal drum - photo 8"
Mast 1 to N shore = 47'; to South shore = 214'

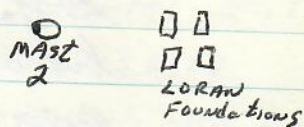
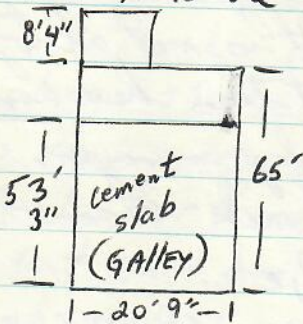

Loran foundations = 6'7" x 3'4"

Round log = 23' x 6'

East Edge of slab to Mast 2 = 181'6"

Mast 2 to N shore = 44'; to S shore 161'

Mast 2 to Mast 3 = 111'; Mast 3 to S shore = 89'; to N shore = 102'

Mast 2 to Wedge of first Loran foundation = 73'; to second foundation, 85'

Mast 2 to Main 6 = 239'; Main 6 to N shore = 44'; Main 6 to S = 153'

Main 6 to Mast 4 = 61'; Mast 4 to S shore = 96'; to N shore = 96'

Mast 3 to Mast 4 = 132'6"

Mast 3 to Main 6 = 166'6" Felled Main 6 = 114'

Main 6 to Mast 5 = 242'; Mast 5 to N shore = 43'; to S = 156'

Mast 5 to end of vegetation SNEP = ~~235~~ 235' (not on Baseline)

Mast 5 to land's end SNEP = 293'

Mast 4 to Mast 5 = 270'

Mast 1 to tent knoll = 349'

Widest NW portion of Island = 278'

WEST EDGE of slab (Galley) down Baseline to NW edge of island = 275' (near IRON BOAT MOORING)

Tent knoll to end of Sand point = 165'

Photos (Blk & wht) of junk, seals w/oil, picking up oil.

Note underwater machinery at Round - (3+)

Island acceptable to turtle (eg. not washed over) -

8/3 SUN - It appears to be a routine activity to visit other islands for recreational purposes. Latest reason is "looking for oil." However, when found don't do anything but report - no thought of cleaning up. Hazard of Buss weed and other species transfer, note large weeds removed from East. Should stress fault is, not altogether CG men but also orders that put them here and lack of proper control ^{exertion} power by Refuge managers. Radio checks missed, - average one per week - reasons - (thus far) - turn radio off, turn squelch up, etc.

LIMB ELETTE - grows on large coral chunks close to shore - ^{green} stringy.

Hatchling at surface in depression behind tent - surface sand 25

2030
8/4 0400

Remove 6 - 3 released - photos 1100 - EX entire nest
Total 109 live + 4 eggs - released most of hatchlings 1/4 - 1/2 mile West of W-S - most swam into waves - wind. Noted one fledgling BF boobie dive twice at hatchlings, once pick up and drop - possibly second time also. Moved into wind, found several hatchlings - they dove at least 3-4 feet when seeing boat. Before being scared they were swimming along making good progress at approximately 6" beneath surface. Sun was high and slightly in "down wind" quadrant.

Note - that rusted iron post is located in front of tent - possibly a marker for landing crafts? Not like Coast and Geodetic marker on Trig.

PROGRESSION OF SEAL PUP COLOR = BLACK → GRAY/SILVER → LIGHT TAN/BROWN. NO ALBATROSS AROUND.

8/5 AM

Ghost Crab count (low tide) N Point to tent = 78 tent to S = 46

SEAL NOTES: As evidenced by tags and scar patterns

8/5 Tues.

8/5 PM

8/5 Tues. observed, individuals come ashore for a few days and then leave. During night, a few pups have been seen floating asleep belly up close to shore. Is this how they sleep at the "fishing grounds"? Pups and smaller SAs are often together - seen playing. One observation may have been SA trying to copulate pup. Through this close shore interaction, is this how pups are assimilated into seal life? Seal "Runs" along E shore are well formed, some evidence (212) suggests that same general hauling sites are regularly used by same Seal. Pair formation (and "guarding" by male) have been evident since arriving at W-S, although not noted in censuses regularly.

Commendations: Assistance with Boat-motor, launching, departures, repair, miscellaneous equipment (Burr weed)
express
Concern: MISSED RADIO CHECKS; REPEATED LANDING ON OTHER ISLANDS OR Motoring close along shore; NOT cleaning up or concerned about oil (even though this is excuse for visiting other islands); Chemicals stains in FW room, not cleaned; Dogs

Notes on Captive released: 1466 = head turned mostly brown, from black centers there are gold radiations in laminae. Dorsal limb scales BIK. 1615, 1442 = Brown head, "clear" spots in laminae, black dorsal limbs, more black pigment in laminae than 1616.

8/5 PM

VISITED EAST- AREA 10 AND PART OF 9 BEING CUT BAD BY WAVE ACTION. T78 BASKING SEP. 48 HATCHLINGS EX A5. HERTZ INDICATED HE RECEIVED ORDER TO SURVEY ALL ISLANDS - MEP COMING END OF MONTH (MARINE ENVIRONMENT PROTECTION)
evening 1800
Yesterday hatchlings found by tennis courts - Dogs killed one. Doc indicated that no seals bask on Tem beach - Dogs chase them back - wait for them to start to come out of water. Tennis lights probably distract hatchlings from W-S and TRIG.

8/6 WED ARE HYBRIDS KNOWN IN Ghost Crabs? EX Central W-S - 10 live;
 12 live. Whale-Skate measurements = Central, E,
 vegetation to high tide 8'-10'; at Beach Rock, S =
 125'; Central, just north of W stump = 86';
 North end (skate) at log in center = 125';
 at this location it is ~ 115' from East ~~to~~ vegetation
 to high tide mark; Widest part of Skate = 185'.
 Pregnant seal observed with 17 shark scars on back
 no tag. Disassembled camp at ~ 1700, to
 TRIG Paul Tern. ON 8/5 Dug down into SP nest 6/10 T40,
 water washing over, eggs sturgid, removed one examined content -
 live embryo | ← → | approximately, recovered. Richard
 ETC reports that turtles were eaten by CG in 1964
 3rd type of ULVA AMIZO.

8/7/75 Thurs Spent night on Tern - Depart FAA w/R. Iversen,
 visited FFS concerning cooperative fisheries patrol
 also [LCDR Paul V. L. Hooper Jr, USCG for an
 A/C station, APO San Francisco 96305] shark-turtle

8/26/75 TO FRENCH FRIGATE SHOALS w/J. BIRNIE - P. SEKORA
 TUESDAY Bob Hyatt Pilot - strong tail wind - fairly calm seas - color
 and BIKWT Photo NIHOA - Telephoto. Cromwell arrived
 ~ Monday Lt comm. ~ 6 people on East / left ashore ~ 2 hrs -
 Foul CoCo palm and bottles in file. possibly Shimura
 Photographed turtle laying / spent 8/27 on W-S
 Thurs
 8/28/75 TO HONO - w/ Whitfield, Teeple, Hyatt - BIKWT Photos KAULA

Joel Whitefield

Box 428

Burnet Tex.

78611

Summary of information on 1975 Recovery
made by Sekora

Tag 118 Honolulu Aug 13, 1975 Lisianski - Basking

width - 22.5

length - 27.5

Plastron length - 22.1

27.5 x 22.5 curved or straight?

original data on 118 transmitted by Sekora 1/23/76

"Tagged at Lisianski Island Sept 19, 1966
measurements 20 1/2 x 18"

Eloped time = ~ 10 years, one month

Assume to
be curved (SHB)

also at Lisianski on Aug 13, 1975 a

basking male was tagged 1125 Kailua?

and measured 32.4 x 23.9 PL 22.5

on Aug. 9, 1975 2 adults were
observed on Laysan Island

See Page 117

Pole 1 to N shore = 47' to South Shore 214'

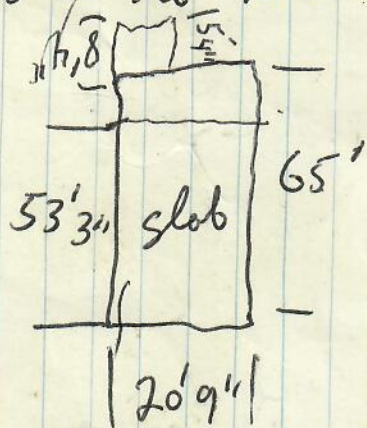

8/3/75

edges of slab to Pole 2 = 181'6"

Pole 2 to N shore = 44'; to S shore 165'

Pole 2 to Pole 3 = 111'

Pole 3 to South = 89'; to N = 102'

Pole 2 to edge of first foundation = 73'

TO East edge 2nd foundation 85'
6'7" by 3'4" foundation

Pole 2 to main 6 = 239'

main 6 to N shore = 44'

main 6 to pole 4 = 61'

~~main 6 to S shore = 153'~~

pole 4 to S shore = 96'

pole 4 to N shore = 96'

Pole 3 to Pole 4 = 132'6"

Pole 3 to main 6 = 166'6"

fell main 6 = 114'

Main to pole 5 292

Pole 5 to N = 43'

Pole 5 to S = 156'

Pole 5 to Veg edge = 235'

Pole 5 to land end 293'

Pole 4 to Pole 5 = 270'

Pole 1 to Tent edge = 349'

Widest NW portion
of Island = 278'

SE edge of slab down baseline
to edge of island = 275'

ROUND LOG 23' x 6'



7216

- check first for first
- first additional points -
- Photograph -
- take as many measurements as possible
- mark points on indicators.
- take down tent -
- bury blocks -
- remove all markers to water -
- check roof -

