

Lil Macmillan

Field notes Kawiahoa

2007

Turtles 2007

Mon	Spot	567-6796
Tues	Lil?	
Wed	Kacey?	
Thurs	Joan	553-5641
Fri	Mike	553-4405
Sat	Lil?	
Sun	Bill	553-9857

check beach for 1<sup>st</sup> tracks

Apr 21 - Lil

Apr 28 - Joan

May 1 - Lil ?

May 4 - Mike ?

May 6 - Bill

8 - Lil

11 - Mike #1

13 AL A5 SPN  
 13' A7 NWME E MG  
 13' A9 river / SE MG  
 18' #9 Phyllis - river  
 18' #10 Scot - 4' river flat  
 19' #11 Scot - 16' W D Bank flat  
 29' #12 kil 50' S E Blot  
 29' #13 kil 41' S Bank  
 33 mile Bto Engl + at  
 38 mile 30P E by Drift  
 38 mile 11 P W Last Path  
 38 mile Bto E MG + AK  
 38 mile + Phyllis drive edge

Pits Can GPS

1	8 1/2	8-1
1	9 1/2	9-1
2	10 3/4	10-2
Bto Scale 1+2		
9P from Bank	1 11 1/4	11-1
at Bank	2 12 1/2	12-1, 12-2
14 P N Bank	1 13 1/4	13-1
40' N of Bank	1 14 1/4	14-1
at E Mgloxy	2 15 3/4	15-2

7/14 - A11  
 7/15 A12 } 8p N E Morn GI  
 A13 }  
 7/16 v #16 } 50' N Lost Path D.  
 v #17 } 91' E  
 v #18 } 77' W " "  
 #19 } 4' W Dicks P  
 7/17 } 50' N E Morn GI  
 v #20 } 36' N of Oki Gr  
 #21 } 89' N of Dead N  
 #22 } 51' N of Oki Gr  
 #23 } 39' N W Morn GI  
 #24 } 8' N of Oki Gr  
 Hatch #3 } NE of Lost post  
 Hatch #4 } - west 7

Pits can GPS

-at Bank	2	17-1
20' N Bank	1	18-2
at Bank	2	19-2
	2	20-2
6' E of Log	2	21-1
26' E of Logs	1	22-2
	2	
	1	23-1
	1	24-1

Match #1 7/17 - Bill.

#4 turtle - last hole 4p 10



#1 GRS 1-1  
mike 1-4  
May 15/67 Est H = 7/9  
Est H = 7/7

#2 May 22/67 Est H July 20

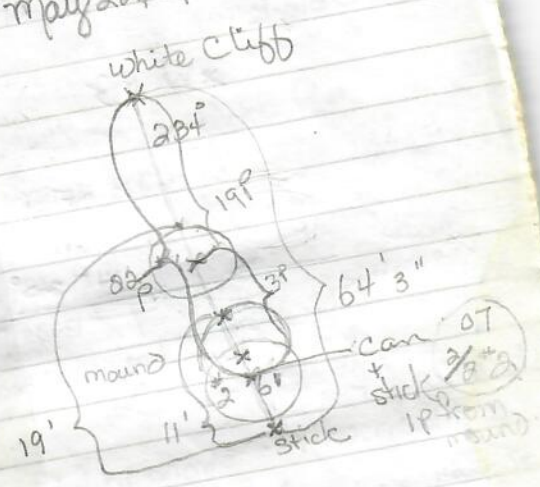

Match #2 July 26 - Joan

Shallow pit  
or blade in?  
or dug earlier? - Strong winds  
were not real fresh water  
to wind to the strong

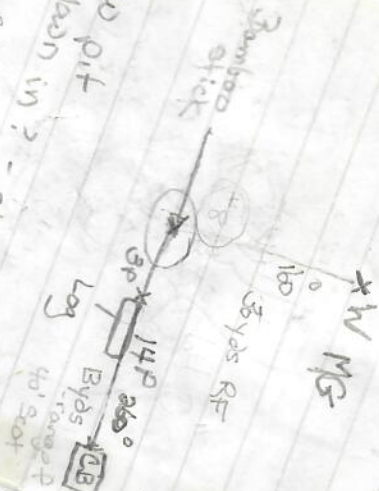

#3  
May 26  
14P E Block  
Est H =

July 25  
4-3

#4 May 27 Bill 3 pits  
Suspect no eggs in #3 - tracked  
uphill before going back to water



Centre  
stick gone - replaced w new stick  
+ clipper  
7/28  
#3 pit  
A3 5/28

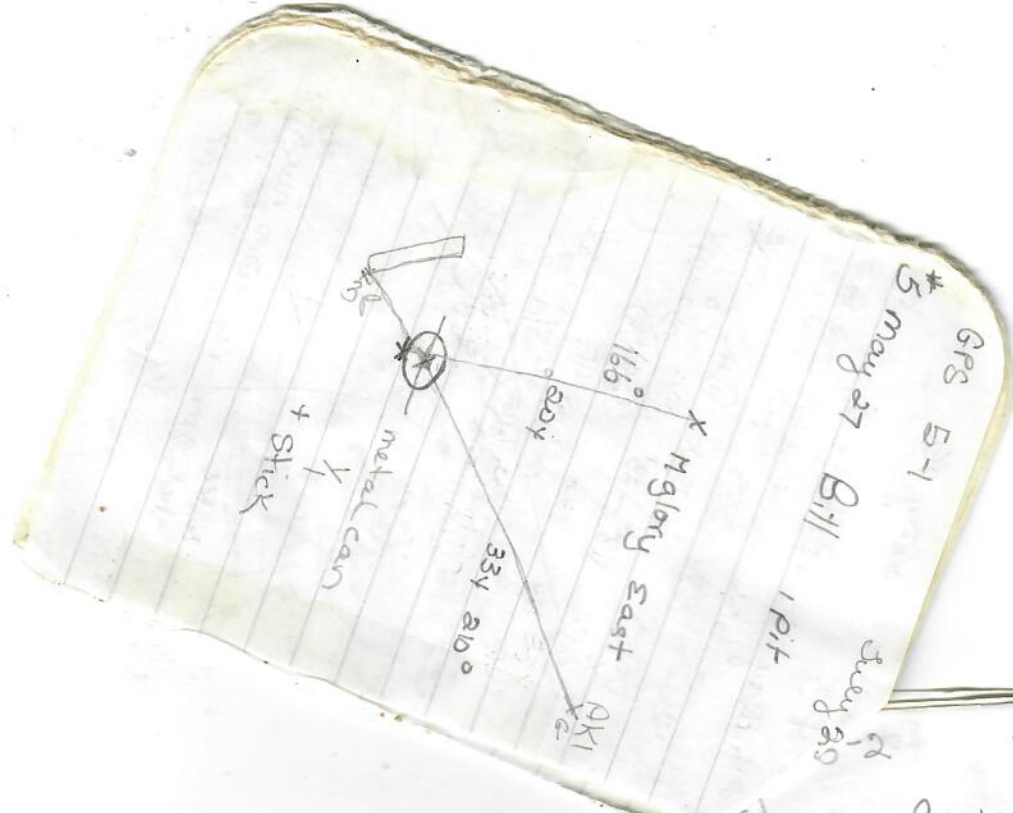

\* GPS B-1  
 5 May 27 Bill 1 pit  
 July 26

6) May 28 Scot 2 pits  
 89' NW AKI Grass

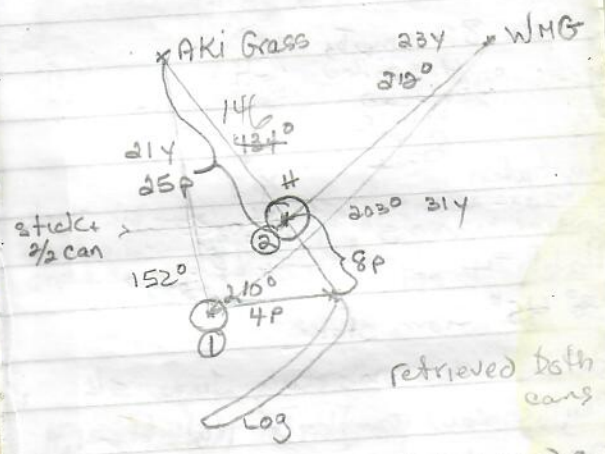

2/2 replaced bear can with labelled sock  
 60 max empty shells + 4 undevel  
 Hatch #3 Aug! Kathy

Over the turtle tracks - not fresh  
 there were several human tracks  
 + marked w/ bit stick - June 5/6  
 by 9<sup>th</sup> tracks were quite windblown  
 Pit tracks saw windblown  
 Phyllis this was dug 2000  
 Believe this was stake

Hatch #4 87  
 several taken by crabs  
 Soda Can #7 retained  
 4 empty  
 1 spoiled  
 0 live  
 (CH)

8/2 82 SW C Block June 9/07  
 6 Pans SW 1 Pit  
 #7 7-1  
 #8 1-8 Est H

Est H - 8/11

#8 Phyllis 1 pit June 13/07  
 15P (144)  $\equiv$  C Block  
 pictures #8, A9

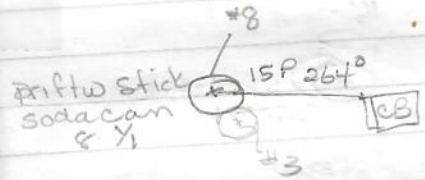

#5 Hatch Aug 17 Mike  
 counted 40 tracks  
 55" due  $\searrow$  from centre  
 78 + 2 spoiled



GRS 09-1

#9

June 18 Scot 10 ft  
Dead Naupaka

Est H

Naupaka

880

At Dicks  
2200

16' Scot

11p

White stick in center  
Soda 91

3370

9p



Est H Aug 16

#10 June 19 Scot 2 pits

41' E lg driftw - Swale 2?

50' S of Bank

Between Swale 1 + 2

2nd pit clearly last dug

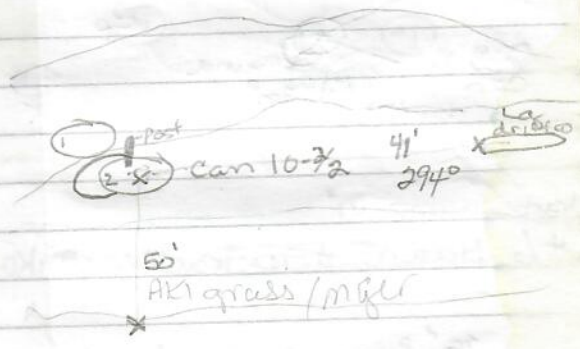

Each sand track 41"

GPS #1 11-1

Est H - 17

#11 June 19 kil 1 pit

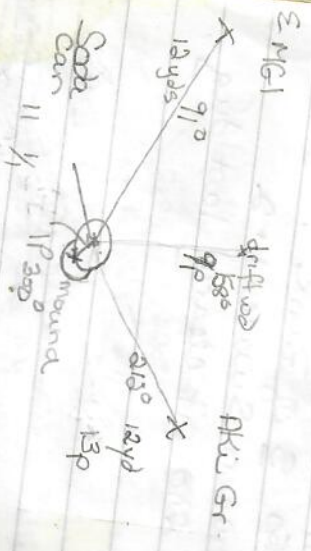

had measured 41'

#6 Hatch +50 tracks - Mike

39' from centre due W

86 i 5 - 3 in open  
Z duplicate of record

#1 #9

Dicks X



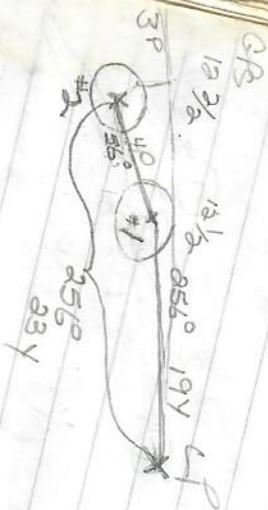

GPS 12 1/2, 12 1/2  
 1/2 Mike June 29  
 30 P E of Last path down  
 at Bank  
 Aug 27

13-1 Aug 27  
 1/3 Mike June 29 1 pit  
 11 P W Last path down  
 14 P N of bank



deep furrows in down track

4" track

4" track hatch

Hatch #7 Aug 29. Bill

33

BP = 13 VP + 3" stick



13Y

88°

176°

13Y

15P

176°

13Y

15P

176°

13Y

15P

176°

13Y

15P

176°

13Y

15P

176°

13Y

15P

176°

13Y

15P

176°

MGE

77 + 1

2 pits

Aug 29

#14 lie

GPs

14-2

Aug 29

East H Sept 1

#15 lil/Phyllis 2 pits July 3  
E M glory at edge of dune

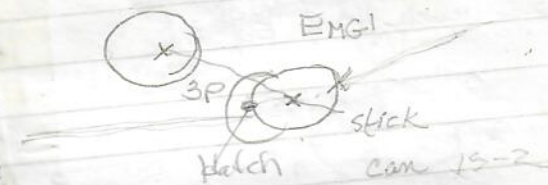

78+3

63° 30"

Hatched Aug 31

3 Sandles

found 1 dead crabs  
shore to land

lot of crab activity - at 241K ocean  
mark Seal track + rest 2-3' spots

Sept - 2 more tracks  
found 1 dead crab

7/16 2 pits  
9' E Lost Path against bank

1st? pit in edge of path  
above beach to E 50'?



Est # 103

Nov 4  
#15 Sept 15 - Lil 2 pits

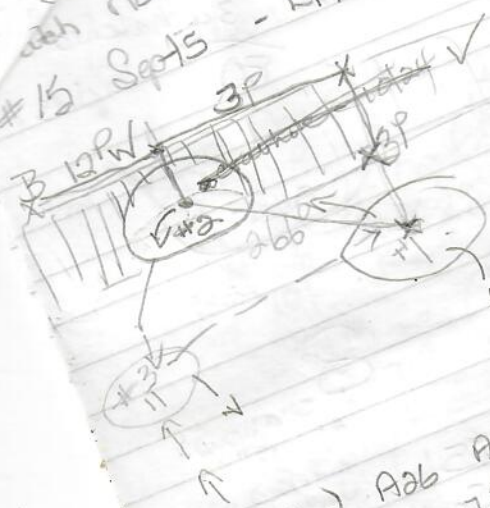

2 aborted A26 A27  
20 PE Kaehu, 17 PW Turtle Ind.  
Sept 12 #1 wet sand returned to  
lower area - chop only 1/2?

Nov 6 hatch #5  
 66 tracks - Scott does not look  
 marked with vertical stick  
 Ocean into a pit  
 2 of last  
 2 of last



Est Hatch Nov 5  
 #16 Forest 9/6 77 shells  
 3 unatched  
 80 pits

4? = nov 19

17 Joe 9/20 2 pits

Dead Naupaka



72 hatched  
 3 unatched  
 1 extra small  
 7 faces  
 15 tracks  
 #1 - 1PW, 6PN } Joe's  
 2 - 6PW, 6PN }  
 Mike 11/24/06 15 tracks

A - Oct 31/06 h/1

high tide line

24 P W turtle ind

Monk Seal tracking

Nov 4/06

monk seal tracks + rests  
B + 1/2 ~~B to~~ AK + E of MGE

	Establish	OK to dig?
# 2	Aug 7	✓
# 14	Oct 21	✓
# 15	Nov 4	?
# 17	Nov 19	?

17-1 Est# 9/14

#17 7/16 1 pit  
77' W Dicko Path 20' N

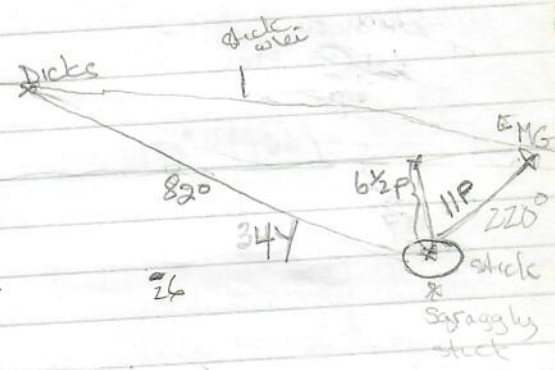

stick missing  
replaced 8/21 need M detect?



\* 18+19 tracks Quad crossed  
 dug shallow pits - Very confusing  
 - Scot + Joan

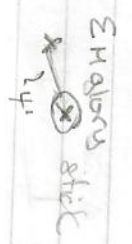

#18 7/16 2 pits  
 4' W of E Haversy - in bank

GFS 18-2 Est # -

#19 7/16 2 pits  
 50' N aki Grass Est # 9/14

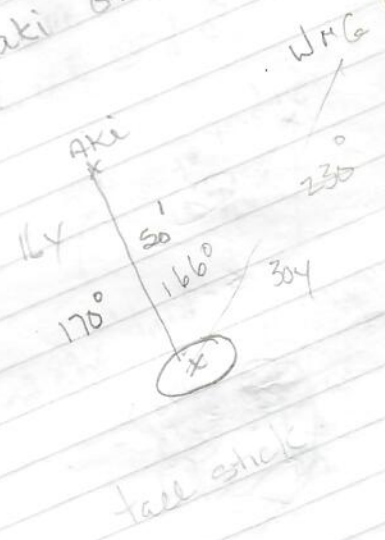

GPS 20-2  
 #30 7/17 2 pits  
 36' N Dead N, 6' from E  
 end of log

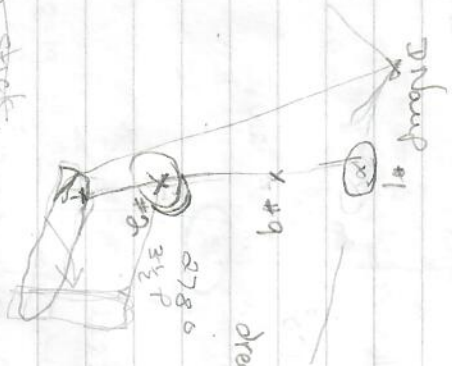

no stick.  
 log moved

Est N - 9/15  
 21-1  
 7/17 1 pit  
 89' N of aki Gr  
 26' E of pile of logs

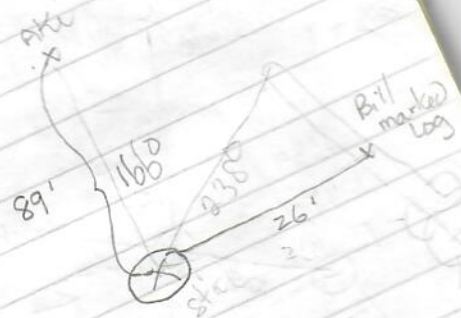

Hatched 9/13/57 - 9am  
found #6 at shore 1 dead, 1 injured

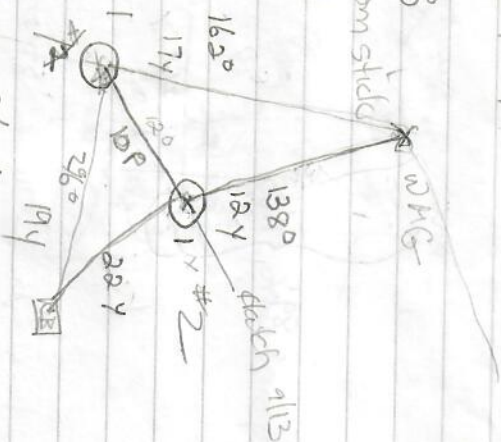

#2a Kothus 7/18 2 pits  
17y N of W Morning G1  
51 #  
-Kothus 9'??

GPs 22-2 Est #

#23 hil July 31  
BY N of aki Grass  
Est # 23-1  
1 pit  
9/29 Est #  
GB 23-

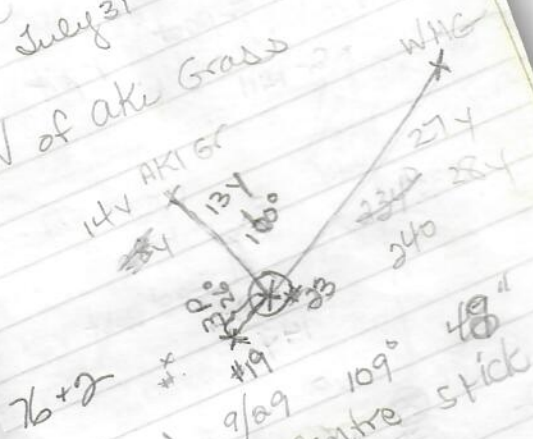

Hatched 9/29  
from centre stick  
stick in centre  
deep furrow in exit track  
19 - tall curved stick  
23 - short rod like stick

GIS 24-1

East X

#24 Kathy Aug 1

20' N fence post 1 pit

45' NE " "

Gr Mill

132°

44'

Load post

144'

214°

stick



75+2

9/29 Hatch 110° 34' Ram

Centre stick

25-1 East # - 10/13  
25-6

#25 Kathy Aug 15 6pds

4P from DP marker  
164°

L Path x

16P to L Path marker  
66°  
can 25-6

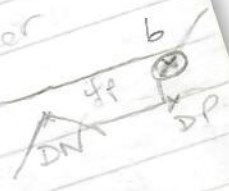

GPS #16  
Compass #19 ✓  
pictures #20  
GPS #20  
GPS #22 -1 ??

CPS - 26-1

Est H =

#26 - Jean Aug 16 1 Pit

2nd D Path + E. Magaly

100 N of dune

D Path

EMG1

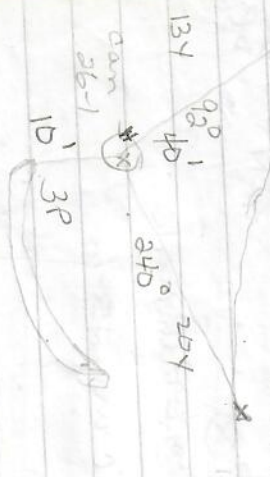

one if hatch 38" 44°  
 16 1 track out

76 + 3 a low

Est H = 10/14

#27 Jean Aug 16

- lg pit N Gravel Hill 1 Pit

E end of Napaka w end of log

G Hill

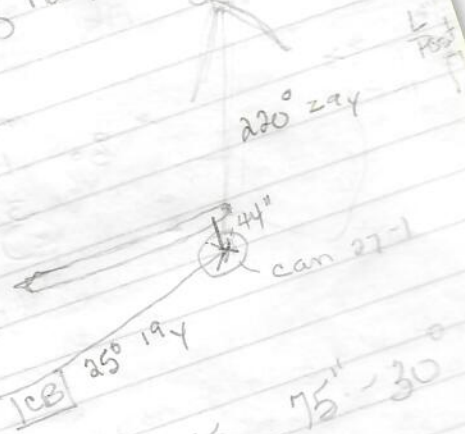

Ice 250 194

Hatch Oct 15 75" - 30°

82 + 2

Sept 1 #3 stick has been removed  
 replaced with  
 Hatch #14 Nov 2 - Mike  
 Nov 3 - Lic + 3 more



GRS 28-1  
 28-3 Est N DG  
 # 28  
 Joan 8/30 3 pigs  
 1-2 Mg 15-20N  
 3-25' E EMg 2-15-20N AKI  
 EMg  
 AKI  
 DMG

Oct 3 - Seal impression 13-20  
 - 3 - Sizzle!

78 empty }  
 3 undeveloped } 81  
 26 dead }  
 1 live }  
 1 more track out 54

SKU#48038



7 35854 6900

Made in China